

REV	CHANGE RECORD AND DATE	CH
A	RELEASE 09/04/03	

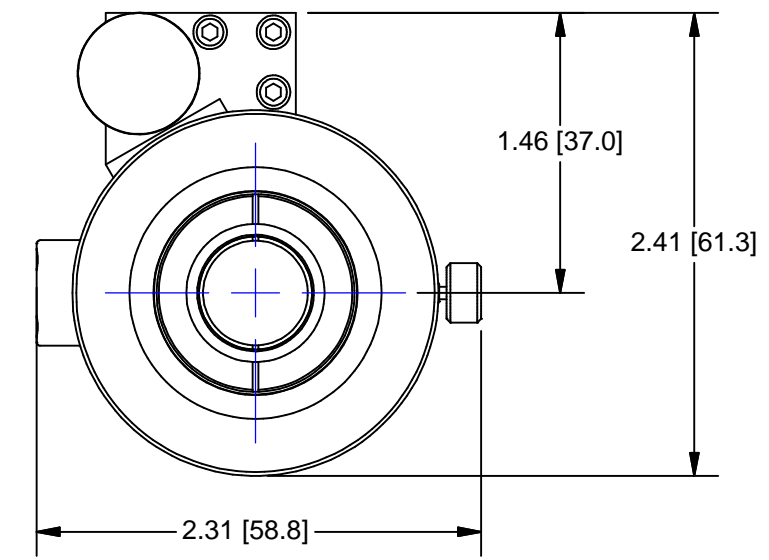

**DC ENCODED PINOUT**

- PIN 1 = MOTOR CH A
- PIN 2 = FAR LIMIT
- PIN 3 = N/C
- PIN 4 = +5Vdc
- PIN 5 = MOTOR +
- PIN 6 = MOTOR CH B
- PIN 7 = NEAR LIMIT
- PIN 8 = COMMON
- PIN 9 = MOTOR -

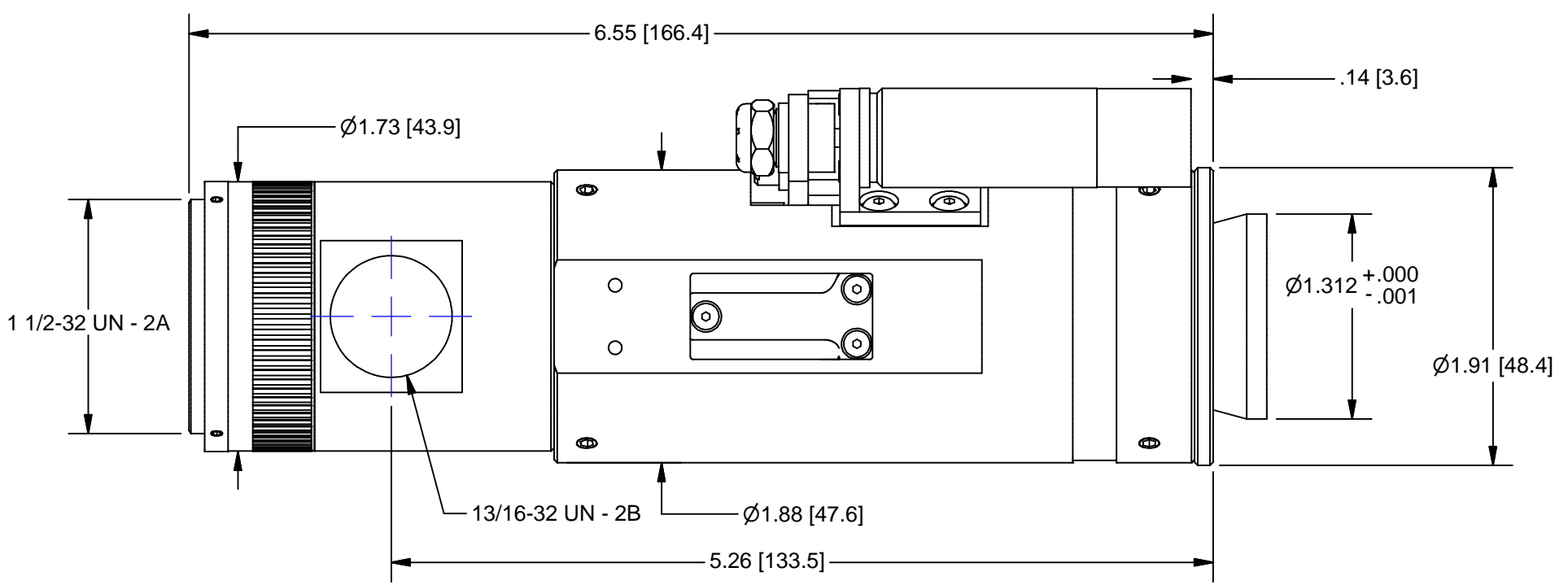
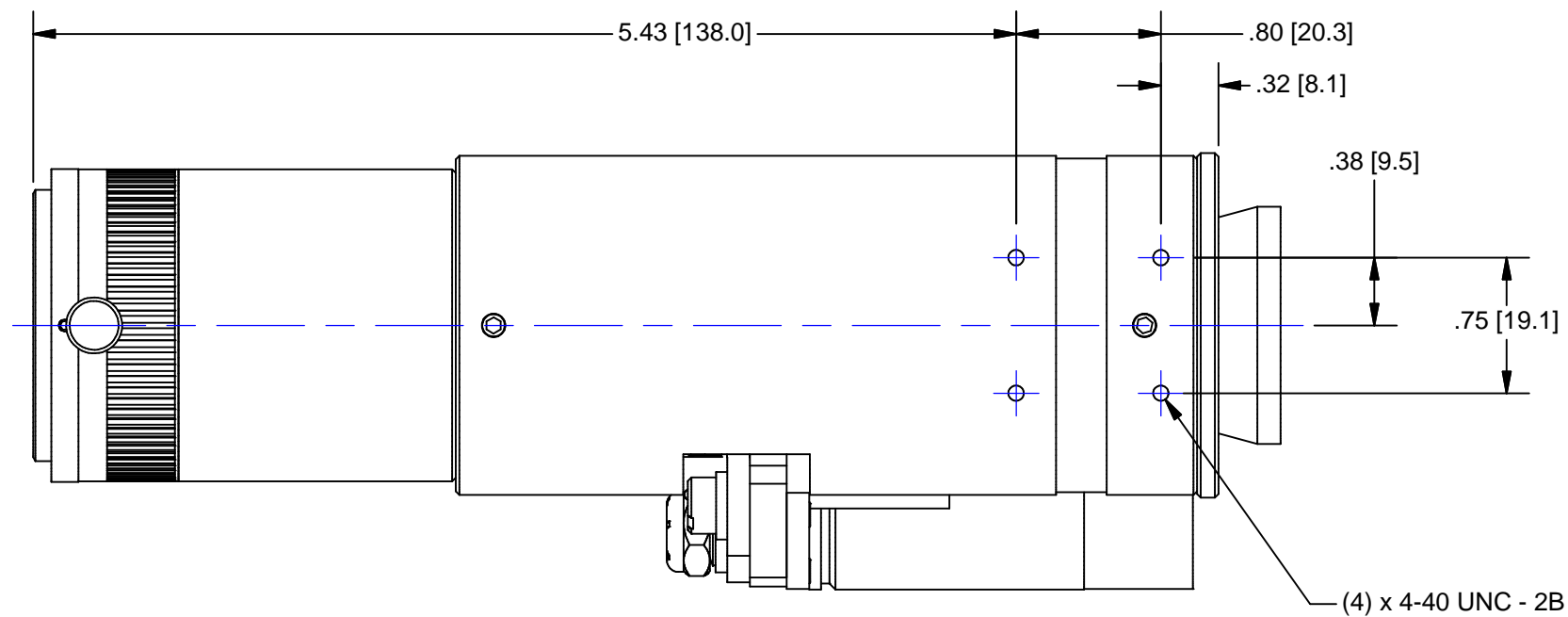
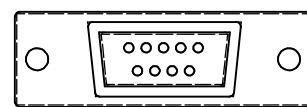

9 PIN MALE D-SUB

**OUTLINE**

**USED ON:**

**MATERIAL:**

UNLESS OTHERWISE SPECIFIED DIMENSIONS ARE IN INCHES AND INCLUDE CHEMICALLY APPLIED OR PLATED FINISHES

**P/N SUFFIX DEFINITION**  
 -1 CONVERSION COATING  
 -2 PAINTING  
 -3 MARKING  
 -R REWORK

THE CONTENTS OF THIS DOCUMENT ARE PROPRIETARY TO NAVITAR. ITS USE IS AUTHORIZED ONLY FOR RESPONDING TO REQUEST FOR QUOTATION OR PERFORMANCE OF WORK FOR NAVITAR

**FINISH:**

**TOLERANCES:**  
 DEC. .XXX ± .005  
 DEC. .XX ± .010  
 FRACT. ± 1/64  
 ANGLES ± 30'  
 CONCENTRICITY .003 TIR  
 BREAK ALL SHARP EDGES .005 MIN. .010 MAX  
 MAX. SURF. ROUGHNESS 32 √

**SCALE: 1:1**  
 DR.: R. PODLENA  
 CH.: P. BONAFEDE  
 APP.:  
 DATE DR.: 9/16/2003  
 DO NOT SCALE DRAWING

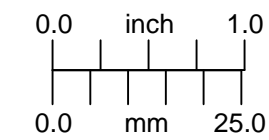

CHAMFER ALL THREADS 30° TO ROOT DIAM.

**NAVITAR**  
 ROCHESTER, NEW YORK

MOTORIZED (ENC) 12X w/2 POS. LS (HE), 3mm FF & COAX PORT

SIZE **B**

**1-51338**  
 SHEET 1 OF 1

REV **A**