

REV	CHANGE RECORD AND DATE	CH
A	RELEASE 09/04/03	

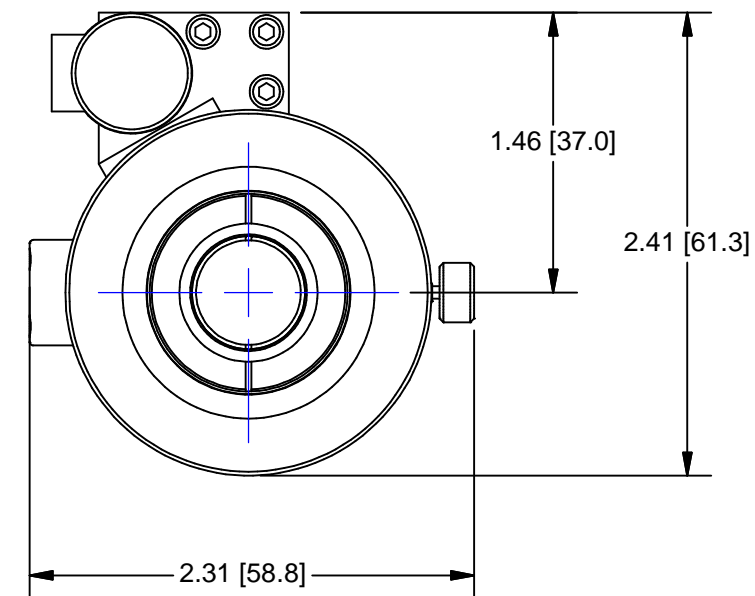
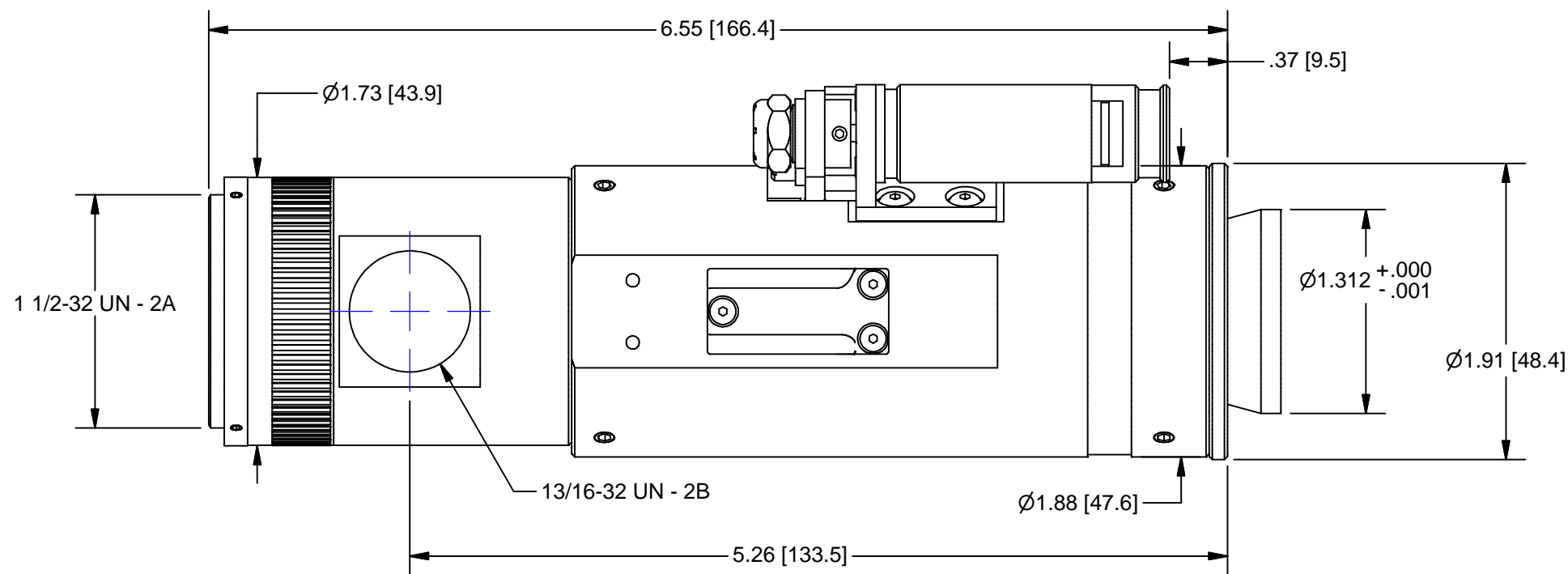
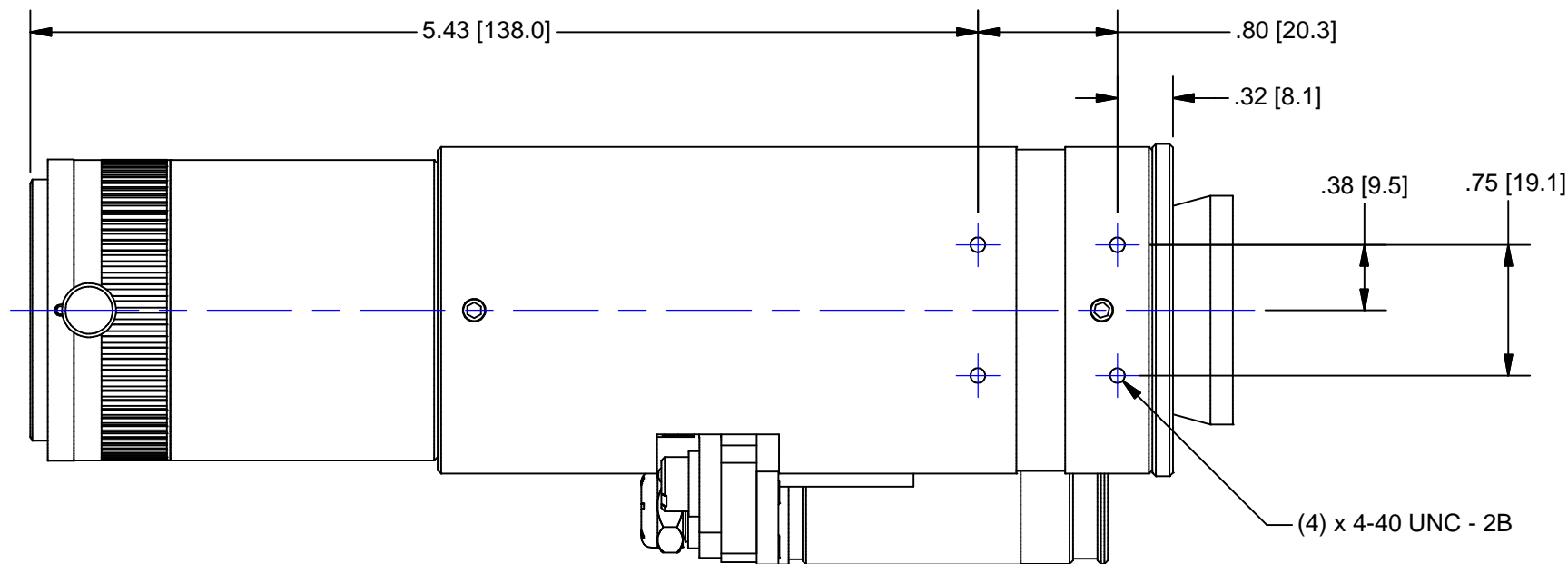

## OUTLINE

### 2-PHASE MOTOR PINOUT

- PIN 3 = +5Vdc
- PIN 13 = COMMON
- PIN 8 = FAR LIMIT
- PIN 12 = NEAR LIMIT
- PIN 1 = MOTOR A+
- PIN 7 = MOTOR A-
- PIN 6 = MOTOR B+
- PIN 11 = MOTOR B-

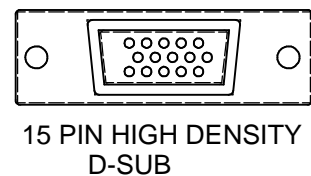

### USED ON:

MATERIAL:

UNLESS OTHERWISE SPECIFIED DIMENSIONS ARE IN INCHES AND INCLUDE CHEMICALLY APPLIED OR PLATED FINISHES

P/N SUFFIX DEFINITION  
 -1 CONVERSION COATING  
 -2 PAINTING  
 -3 MARKING  
 -R REWORK

THE CONTENTS OF THIS DOCUMENT ARE PROPRIETARY TO NAVITAR, ITS USE IS AUTHORIZED ONLY FOR RESPONDING TO REQUEST FOR QUOTATION OR PERFORMANCE OF WORK FOR NAVITAR



FINISH:

TOLERANCES:  
 DEC. .XXX ± .005  
 DEC. .XX ± .010  
 FRACT. ± 1/64  
 ANGLES ± 30'  
 CONCENTRICITY .003 TIR  
 BREAK ALL SHARP EDGES .005 MIN. .010 MAX  
 MAX. SURF. ROUGHNESS 32 √

SCALE: 1:1  
 DR.: R. PODLENA  
 CH.: P. BONAFEDE  
 APP.:  
 DATE DR.: 9/16/2003  
 DO NOT SCALE DRAWING

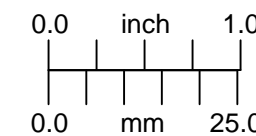

CHAMFER ALL THREADS 30° TO ROOT DIAM.

MOTORIZED (STEP) 12X w/2 POS. LS (HE), 3mm FF & COAX PORT

SIZE B

1-51311 SHEET 1 OF 1

REV A