

Material		N.A.		Mass		1159 g		Scale		1:2			
Surface treatment		N.A.		Part No.		CO29508							
Geometrical tolerance (ISO 2768-2)								Class		K		Description	CMTH080
Linear tolerance (ISO 2768-2)								Class		m			
0.5 ±3	>3÷ 6	>6÷ 30	>30÷ 120	>120 ±400	>400÷ 1000	>1000 ±2000	>2000 ±4000	Undimensioned radii		R 0.5		Drawing No.	Sheet
±0.1	±0.1	±0.2	±0.3	±0.5	±0.8	±1.2	±2	Date		Name			
		Designed		08/10/2019		Vasconetto		Drawing No.		DP 29508-B		Sheet	
		Drawn		03/06/2020		Ccharly		1/2		<i>Secret and confidential - All rights reserved - No copy, dissemination or circulation is allowed unless specifically authorized in writing by OPTO ENGINEERING S.r.l. - Any violation shall be legally prosecuted.</i>			
		Checked		10/06/2020		Rodella							
OPTO ENGINEERING S.r.l. - Mantova, Italy - Tel. +39 0376699111 - www.opto-e.com													

all dimensions are in mm

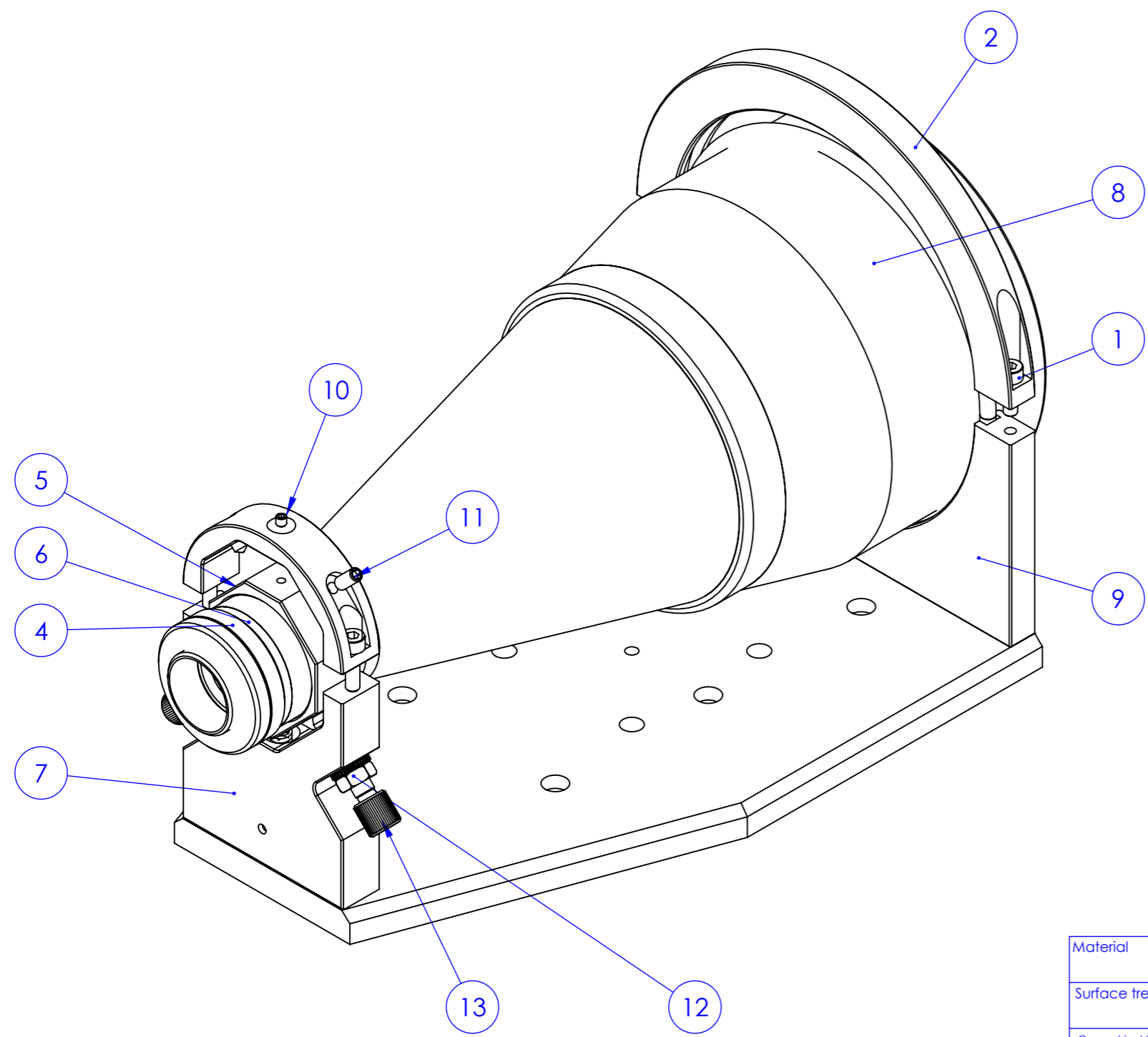

ASSEMBLY INSTRUCTIONS

- Loosen the screws (1) and remove the mechanics (2)
- Remove the lens mount (4) by unscrewing the flange and the screws that lock the mount in place.
- Insert the eyepiece (6) inside the mechanical ring (5). Be careful not to remove the item (5) from the basis (7)
- Tighten the lock screw (10) to fix the eyepiece in place
- Reassemble the lens mount (4) on the eyepiece (6)
- Place the front lens (8) on top of mechanics (9). Ensure that the o-ring seal rope is placed correctly
- Reassembly the half-ring (2) on the top of the lens and gently screw (1)

ALIGNMENT INSTRUCTIONS

- Ensure that screws (1) are gently tightened
- Remove the lock screws (11)
- Unscrew the locking nuts (12)
- Adjust the optical axis orientation using the adjustment knobs (13)
- Once the correct position is found, fix the clamp using the lock screws (11) and the locking nuts (12)
- Firmly tighten the screws (1)

Material		N.A.		Mass		N.A.		Scale		1:1.5	
Surface treatment		N.A.		Part No.		CO29508					
Geometrical tolerance (ISO 2768-2)				Class	K	Undimensioned bevels		0,5x45°			
Linear tolerance (ISO 2768-2)				Class	m	Undimensioned radii		R 0.5			
0.5 ±3	>3÷ 6	>6÷ 30	>30÷ 120	>120 ±400	>400÷ 1000	>1000 ±2000	>2000 ±4000				
±0.1	±0.1	±0.2	±0.3	±0.5	±0.8	±1.2	±2				
 OPTO ENGINEERING		Date		Name		Drawing No.		Sheet			
		Designed		08/10/2019		Vasconetto		DP 29508-B		2/2	
		Drawn		03/06/2020		Ccharly					
Checked		10/06/2020		Rodella							
OPTO ENGINEERING S.r.l. - Mantova, Italy - Tel. +39 0376699111 - www.opto-e.com											
<i>Secret and confidential - All rights reserved - No copy, dissemination or circulation is allowed unless specifically authorized in writing by OPTO ENGINEERING S.r.l. - Any violation shall be legally prosecuted.</i>											

all dimensions are in mm

