

Rev No.	Description	Date	Name
B	Phase adjustment	08/11/2016	Rodella

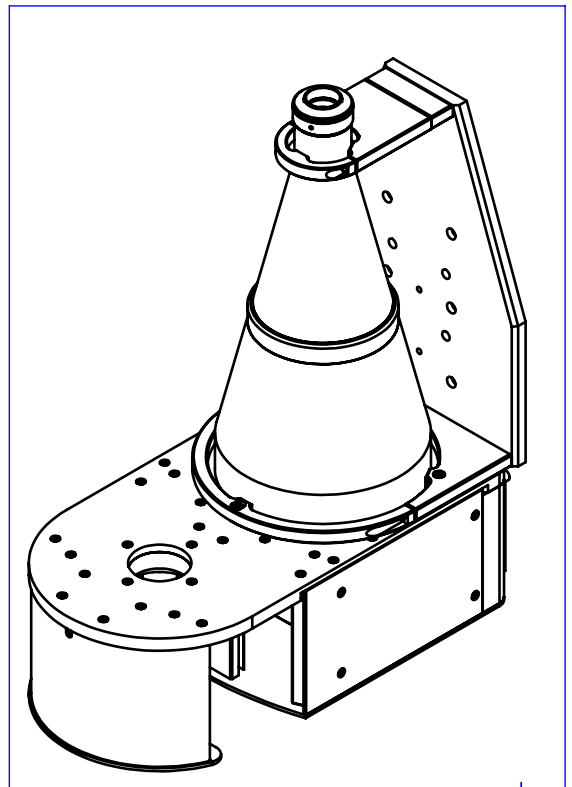
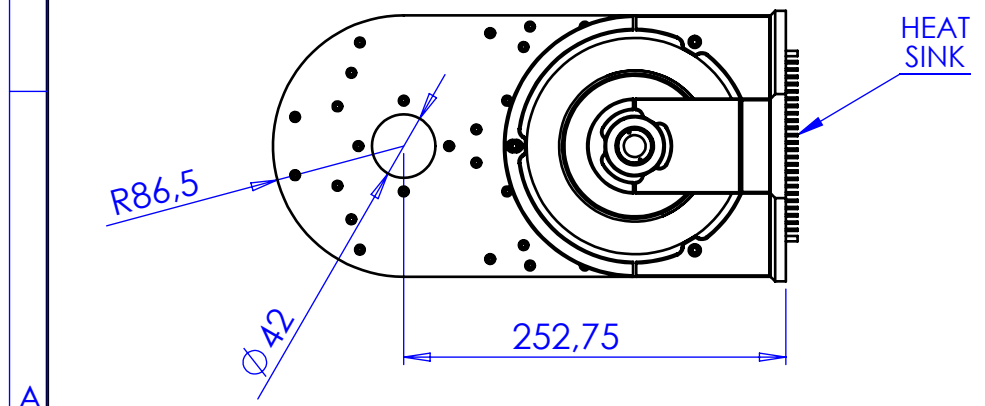
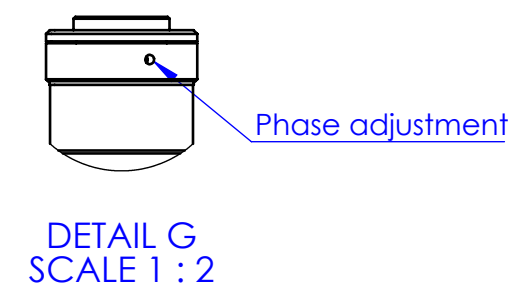
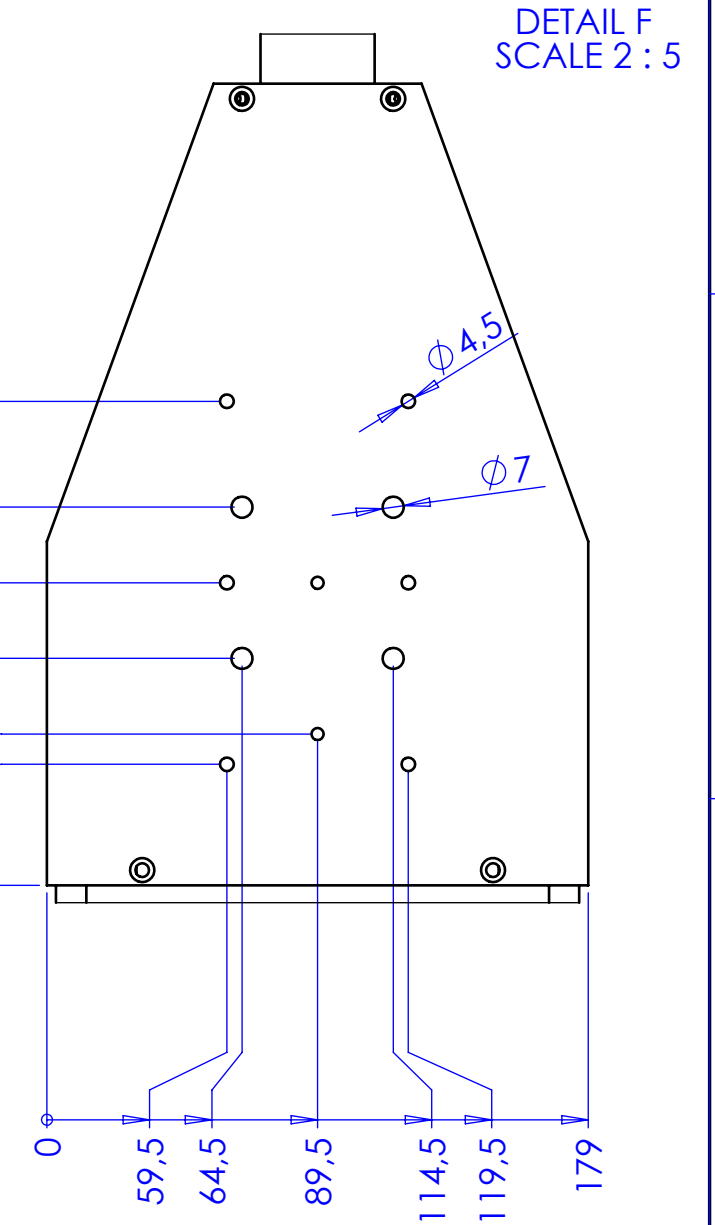
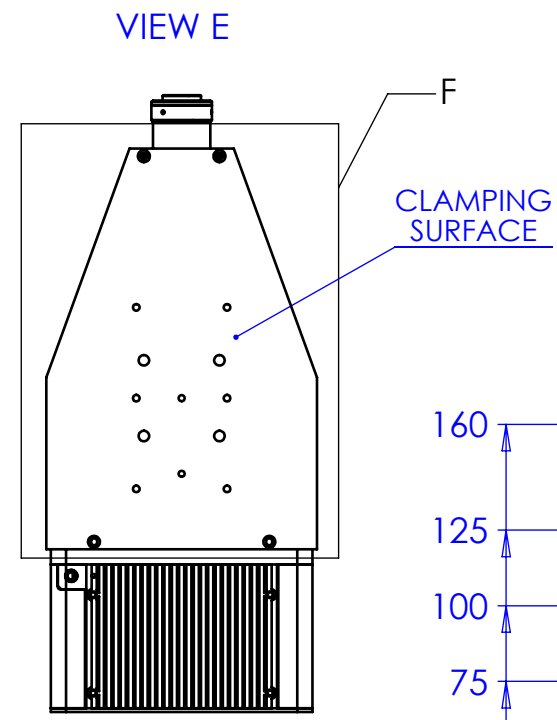
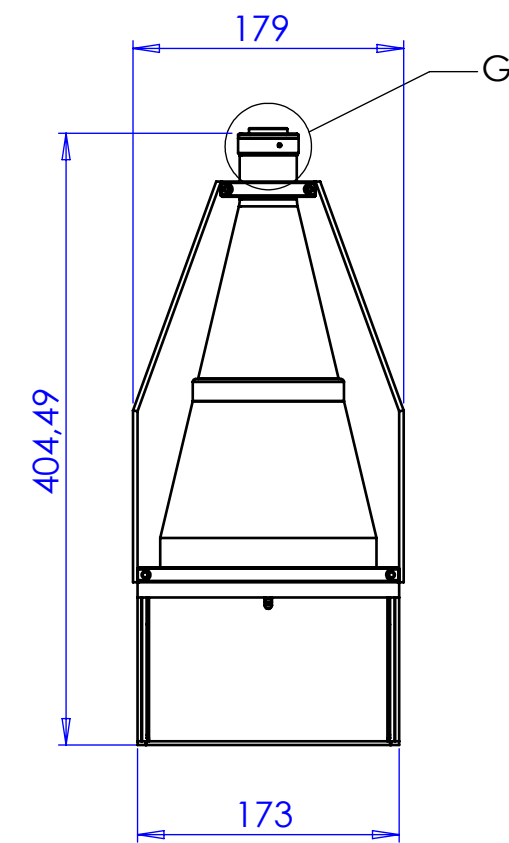
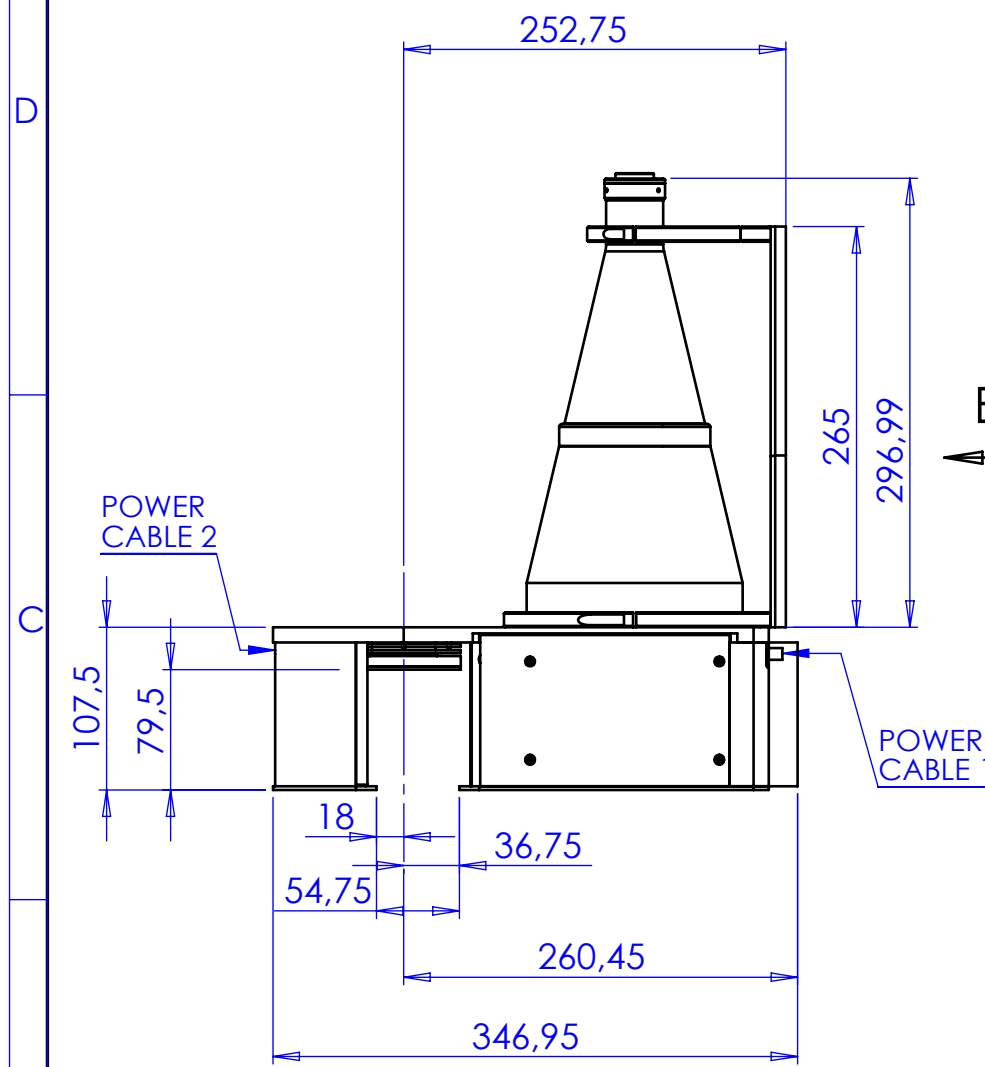

Material	N.A.	Mass	6862 g	Scale	1:5
Surface treatment	N.A.	Part No.	CO22465		
Geometrical tolerance (ISO 2768-2)		Class	K	Undimensioned bevels	0,5x45°
Linear tolerance (ISO 2768-2)		Class	m	Undimensioned radii	R 0,5
0,5 ±3	>3±6	>6±30	>30±120	>120 ±400	>400±1000
±0,1	±0,1	±0,2	±0,3	±0,5	±0,8
		>1000 ±2000	>2000 ±4000		
		±1,2	±2		
		Date	Name	Drawing No.	Sheet
		19/03/2014	Vasconetto	DP 22465-B	1/1
		26/05/2014	Vasconetto		
<p>all dimensions are in mm</p> <p>OPTO ENGINEERING</p> <p>OPTO ENGINEERING S.r.l. - Mantova Italy - Tel. +39 0376 699111 - www.opto-engineering.com</p> <p>Secret and confidential - All rights reserved - No copy, dissemination or circulation is allowed unless specifically authorized in writing by OPTO ENGINEERING S.r.l. - Any violation shall be legally prosecuted.</p>					