

1 2 3 4 5 6 7 8

D

C

B

A

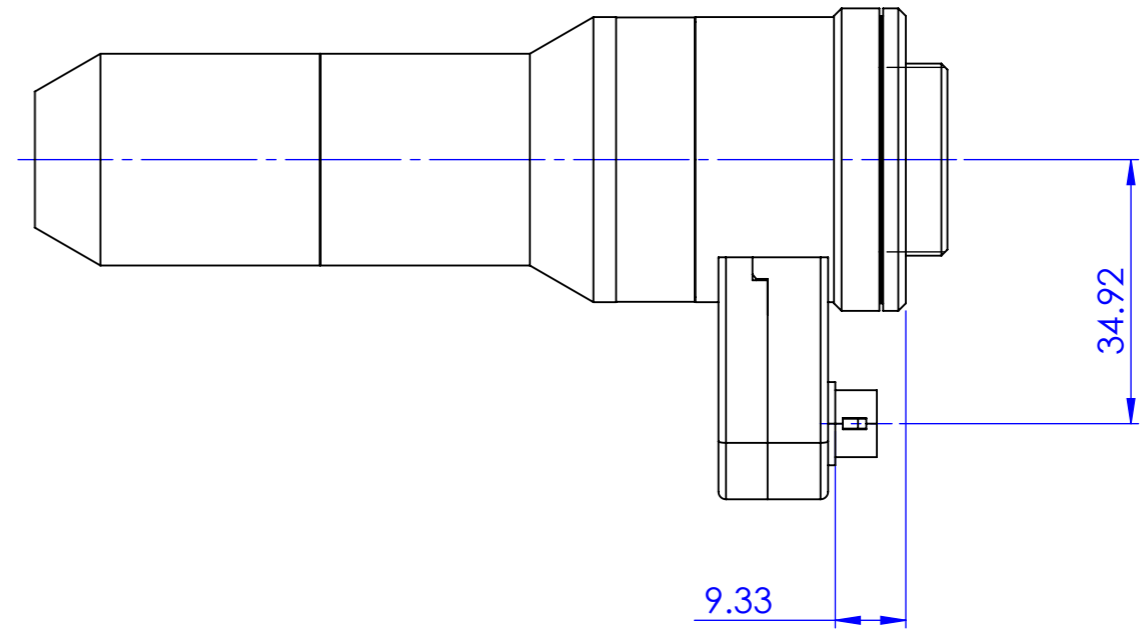
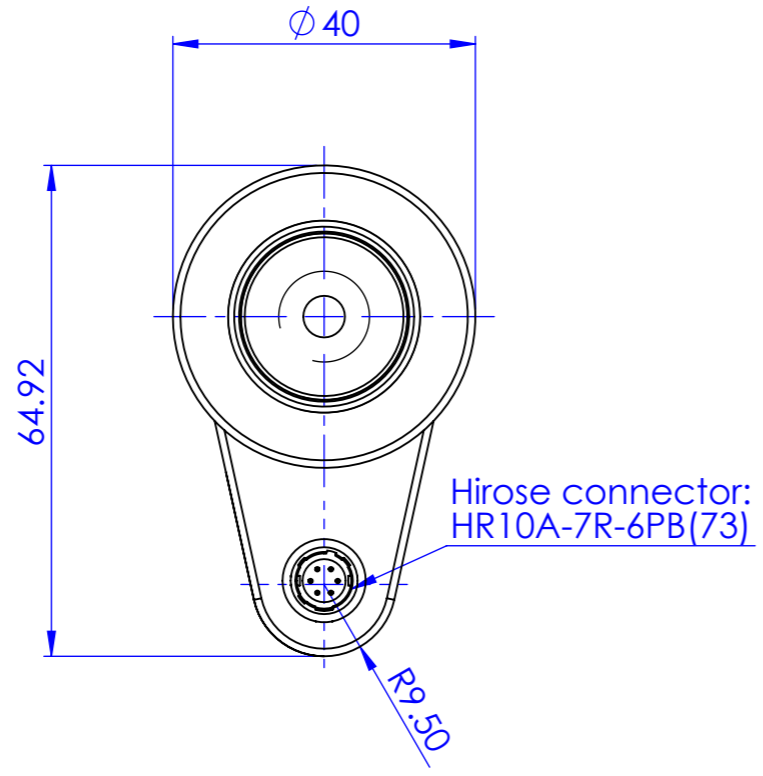
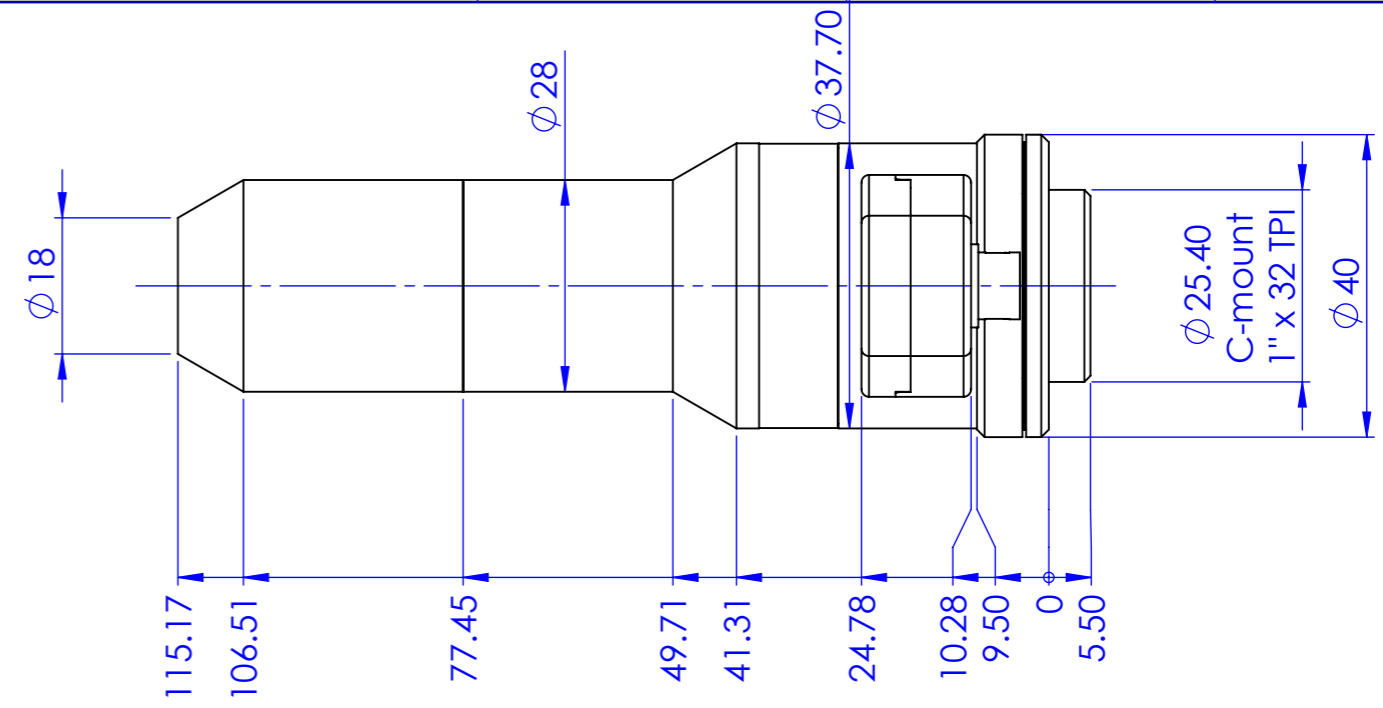

Focusing lens: Optotune EL-3-10

Connector pinout:

Pin number	Signal
1	Lens + control pin
2	Lens - control pin
3	Not connected
4	Not connected
5	Not connected
6	Not connected

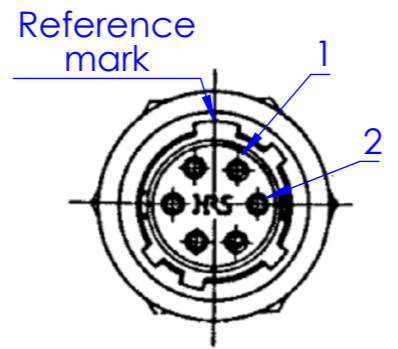

Material		N.A.		Mass		266.665 g		Scale		1:1	
Surface treatment		N.A.		Part No.		CO29856					
Geometrical tolerance (ISO 2768-2)				Class	K	Undimensioned bevels		0.5x45°			
Linear tolerance (ISO 2768-2)				Class	m	Undimensioned radii		R 0.5			
0.5 ±3	>3÷ 6	>6÷ 30	>30÷ 120	>120 ±400	>400÷ 1000	>1000 ±2000	>2000 ±4000	Description		PCHI023-AF	
±0.1	±0.1	±0.2	±0.3	±0.5	±0.8	±1.2	±2	Drawing No.		DP 29856-A	
		Date		Name		Drawing No.		Sheet		1/1	
		Designed		Rodella		DP 29856-A					
		Drawn		Vasconetto							
		Checked		Bertolucci							
all dimensions are in mm OPTO ENGINEERING S.r.l. - Mantova Italy - Tel. +39 0376 699111 - www.opto-engineering.com											
Secret and confidential - All rights reserved - No copy, dissemination or circulation is allowed unless specifically authorized in writing by OPTO ENGINEERING S.r.l. - Any violation shall be legally prosecuted.											

1 2 3 0 1 2 3 4 5 6 7 8 9 10 6 7 8