

Rev No.	Description	Date	Name
A	First light	09/05/08	A.Vismara

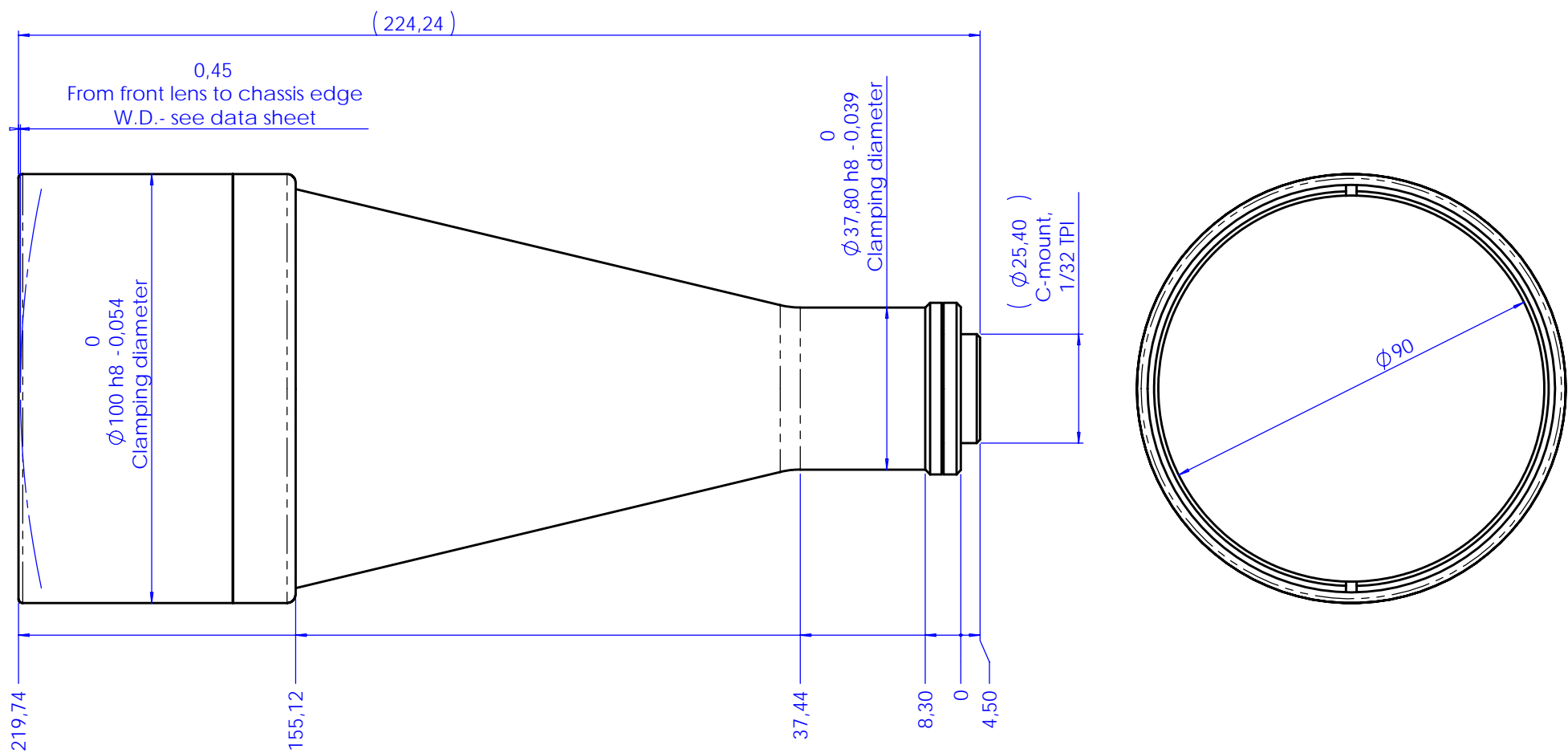

Material	N.A.		Mass	1.1 kg	Scale	1:1		
Surface treatment	N.A.		Project-Prod.Item/Instrument Telecentric lens UV 12 64					
Geometrical tolerance (ISO 2768-2)		Class	K	Description				
Linear tolerance (ISO 2768-2)		Class	m	Undimensioned bevels	1x45°	Assembly		
0.5	>3-	>6-	>30-	>120	>400-		>1000	Undimensioned radii
+3	6	30	120	+400	1000	+2000		
±0.1	±0.1	±0.2	±0.3	±0.5	±0.8	±1.2		
		Date	Name	Drawing No.				
www.opto-engineering.com		Designed	09/05/08	A.Vismara	02629-0-A			
		Draw	09/05/08	A.Vismara	Sheet			
		Checked	X	C. Sedazzari	1/1			
OPTO ENGINEERING S.r.l. - 46100 Mantova Italy - Via Cremona, 29/2 - Tel. +39 0376 263565 - e-mail: info@opto-engineering.com - http://www.opto-engineering.com							Reproduction forbidden without specific authorization	

