

Rev No.	Description	Date	Name
B	approvazione	15/07/2014	Rodella

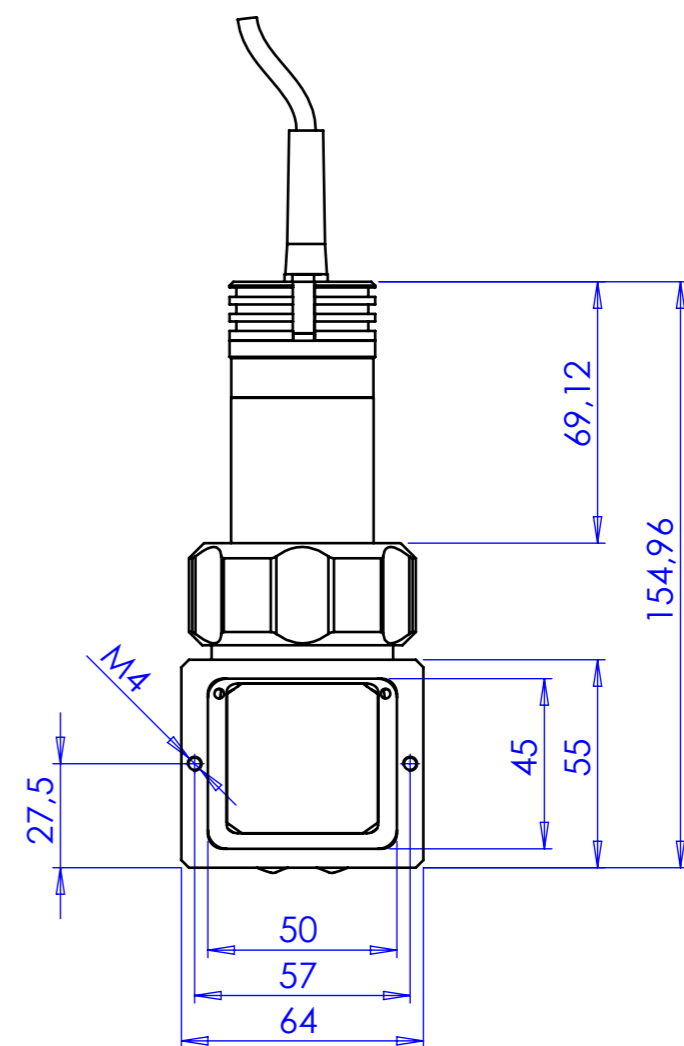
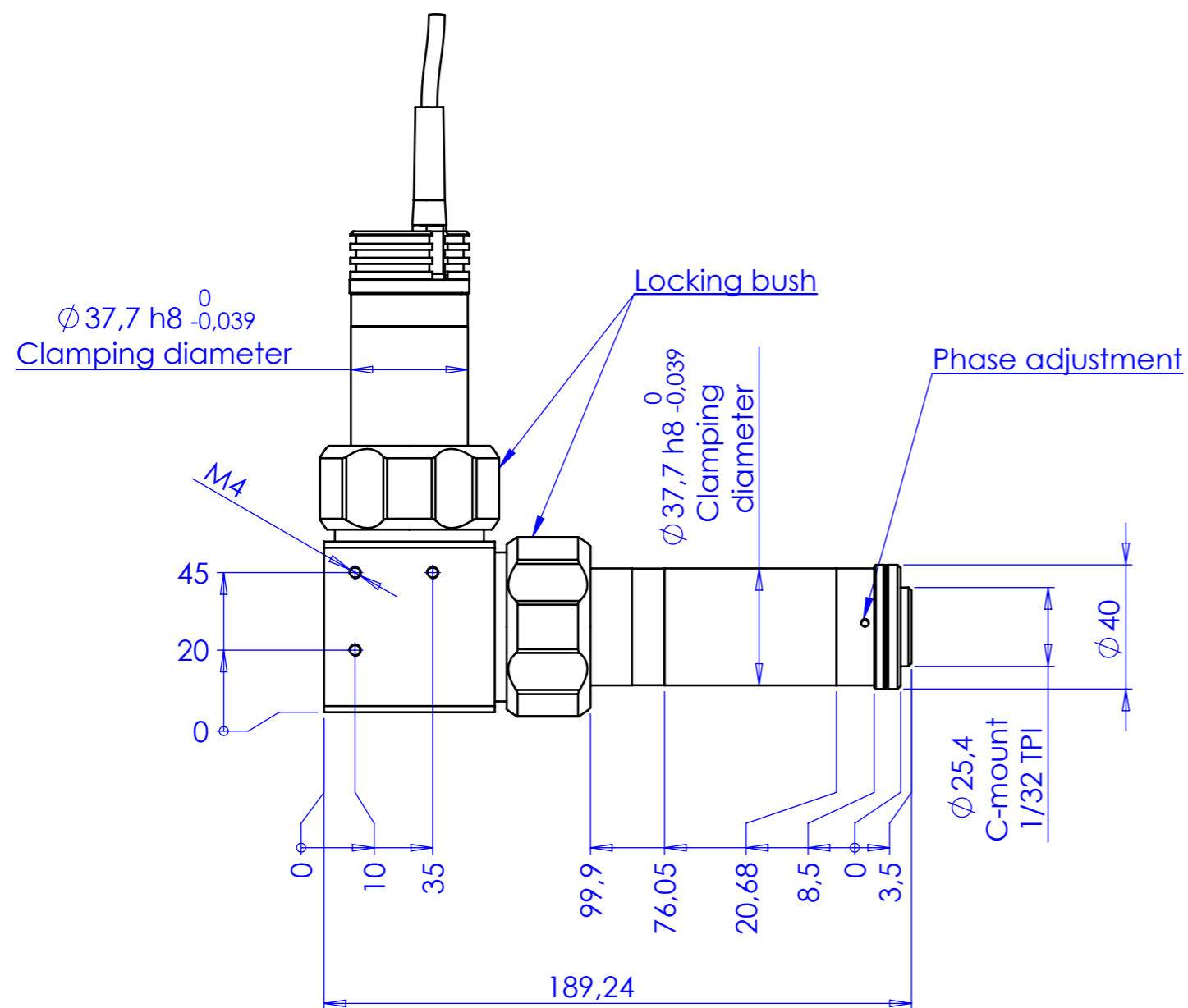

Material		N.A.		Mass		982 g		Scale		1:2		
Surface treatment		N.A.		Part No.		CO71599						
Geometrical tolerance (ISO 2768-2)								Class		K		Description
Linear tolerance (ISO 2768-2)								Class		m		
0.5 ±3	>3± 6	>6± 30	>30± 120	>120 ±400	>400± 1000	>1000 ±2000	>2000 ±4000	Undimensioned bevels		0,5x45°		TCCXQ050-G
±0.1	±0.1	±0.2	±0.3	±0.5	±0.8	±1.2	±2	Undimensioned radii		R 0.5		
 OPTO ENGINEERING THE TELECENTRIC COMPANY		Date		Name		Drawing No.		Sheet		<i>Secret and confidential - All rights reserved - No copy, dissemination or circulation is allowed unless specifically authorized in writing by OPTO ENGINEERING S.r.l. - Any violation shall be legally prosecuted.</i>		
		Designed		Rodella		DP 71599-B		1/1				
		Drawn		Rodella								
Checked												
<b>OPTO ENGINEERING S.r.l. - Mantova Italy - Tel. +39 0376 699111 - www.opto-engineering.com</b>												

all dimensions are in mm