

Rev No.	Description	Date	Name

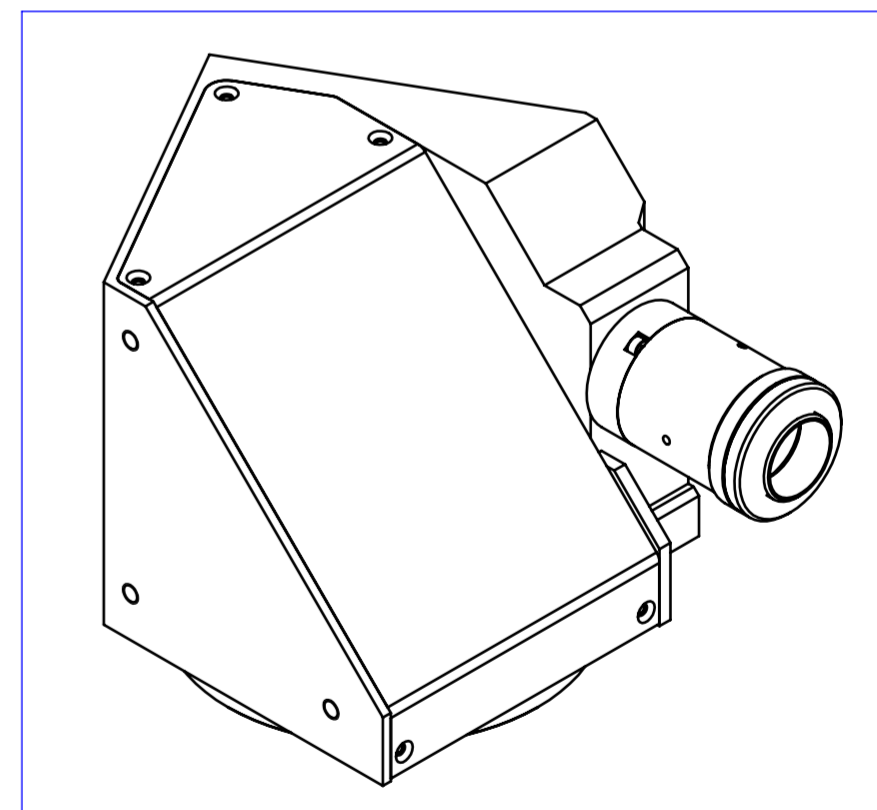
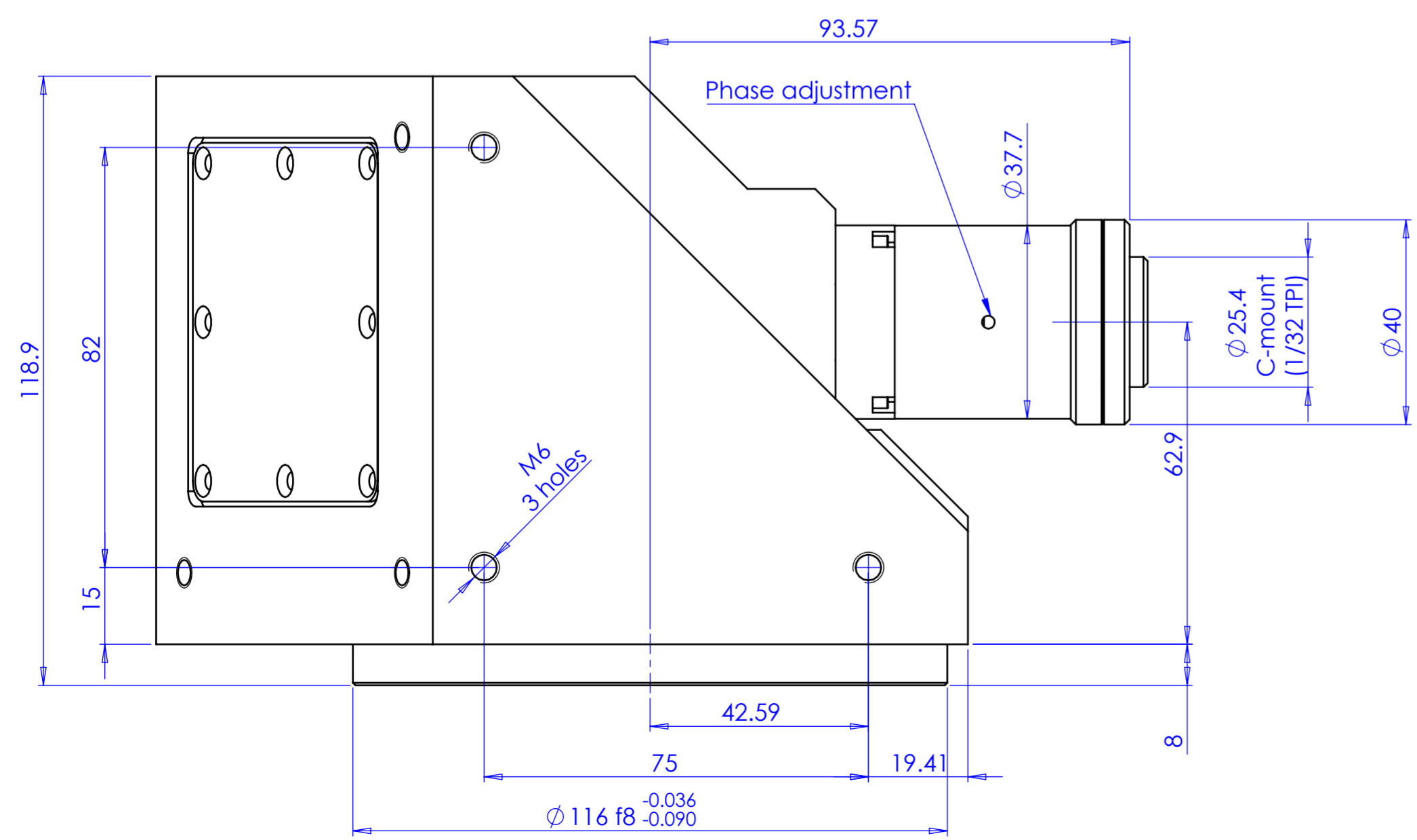
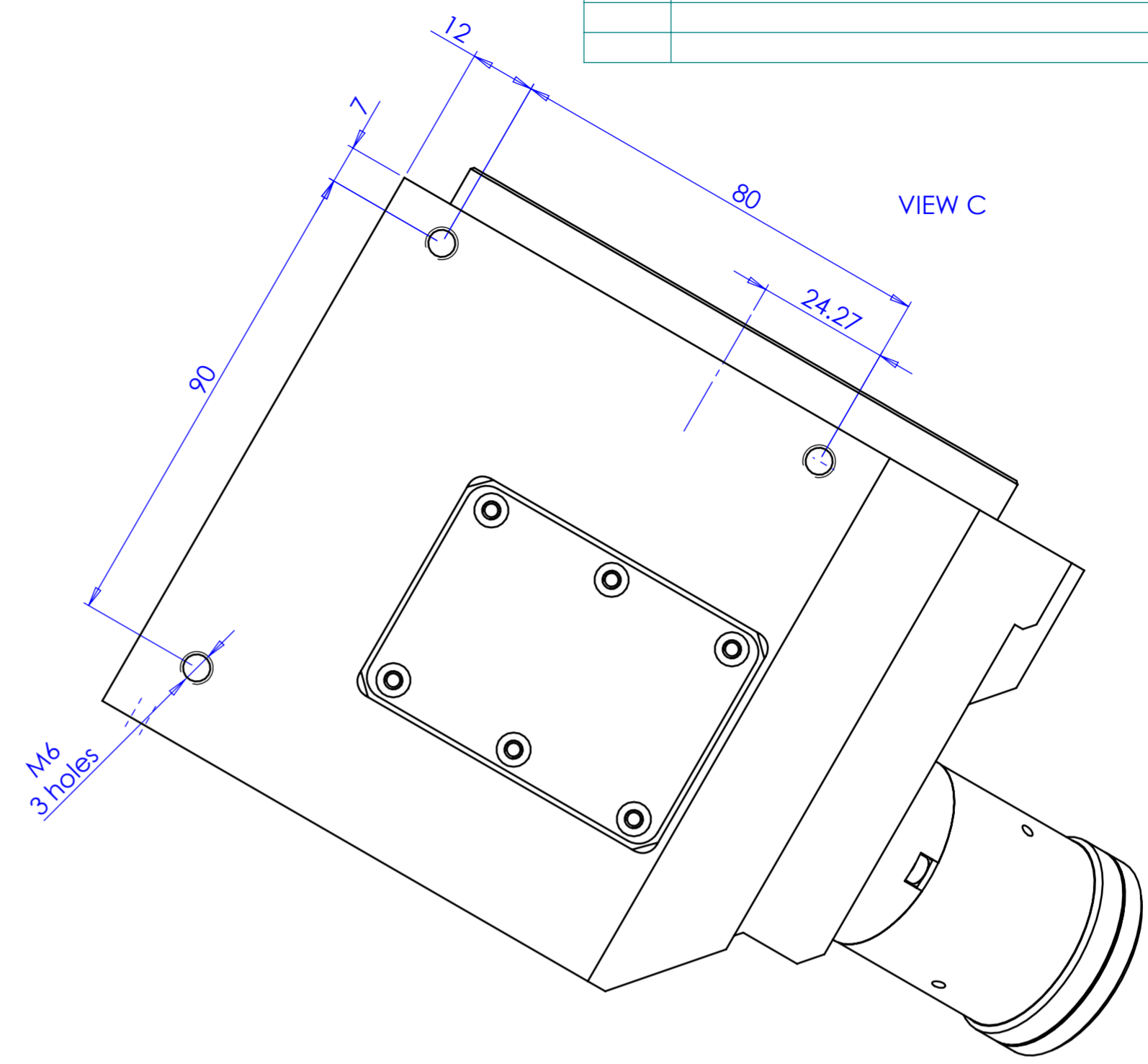
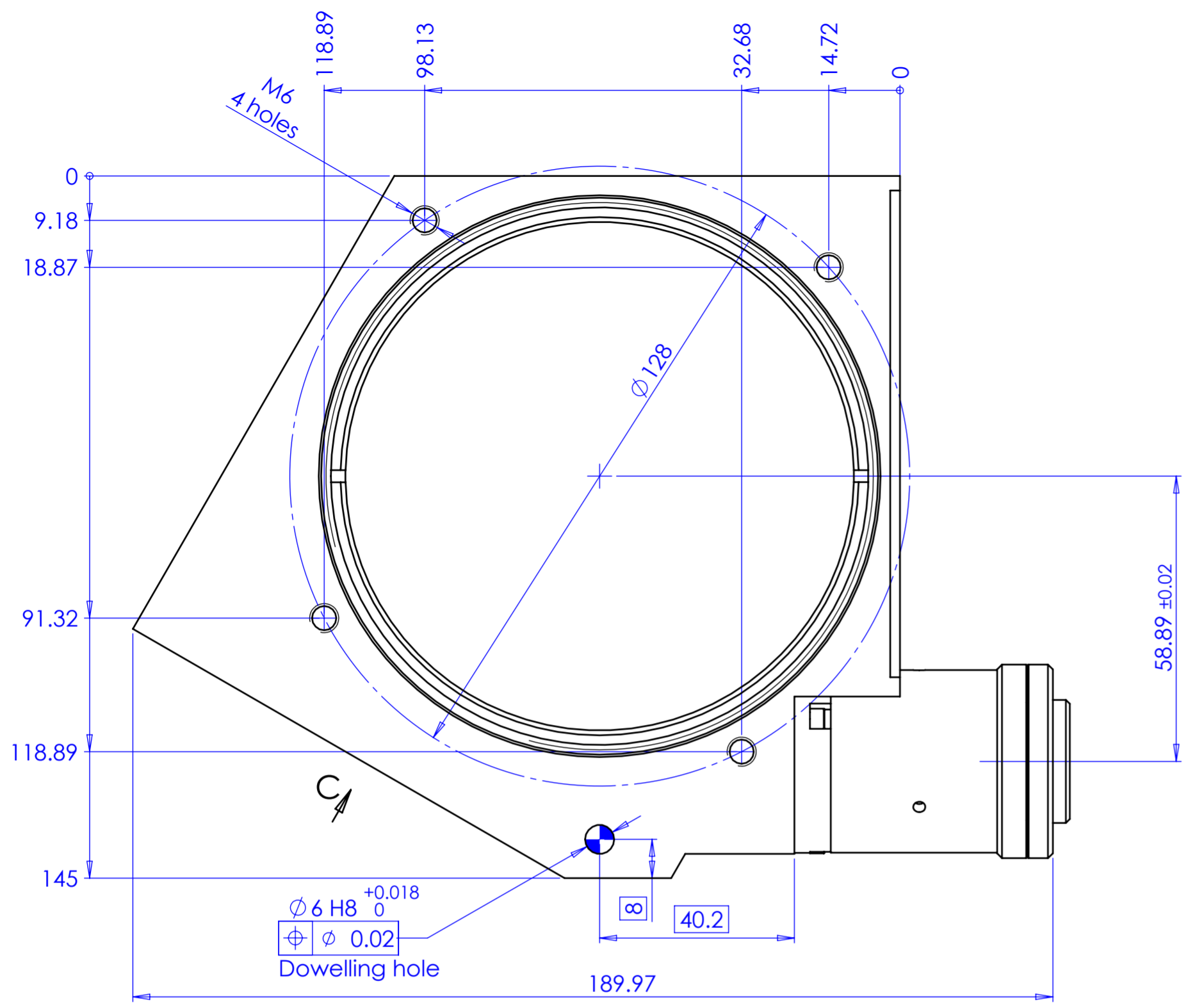

Material	N.A.	Mass	3219 g	Scale	1:1
Surface treatment	N.A.	Part No.	CO28109	Description	
Geometrical tolerance (ISO 2768-2)		Class	K	Undimensioned bevels	0.5x45°
Linear tolerance (ISO 2768-2)		Class	m	Undimensioned radii	R 0.5
0.5	>3+	>6+	>30+	>120	>400+
+3	6	30	120	+400	+1000
±0.1	±0.1	±0.2	±0.3	±0.5	±0.8
					±1.2
					±2
		Date	Name	Drawing No.	
		Designed	14/05/2015	Vasconetto	DP 28109-A
		Drawn	15/05/2019	Rodella	
		Checked			
				Sheet	1/1
OPTO ENGINEERING S.r.l. - Mantova Italy - Tel. +39 0376 699111 - www.opto-engineering.com					

Secret and confidential - All rights reserved -
 No copy, dissemination or circulation is allowed unless
 specifically authorized in writing by OPTO ENGINEERING
 S.r.l. - Any violation shall be legally prosecuted.