

Rev No.	Description	Date	Name
B	Aggiunta regolazione di fase	23/09/2016	Rodella

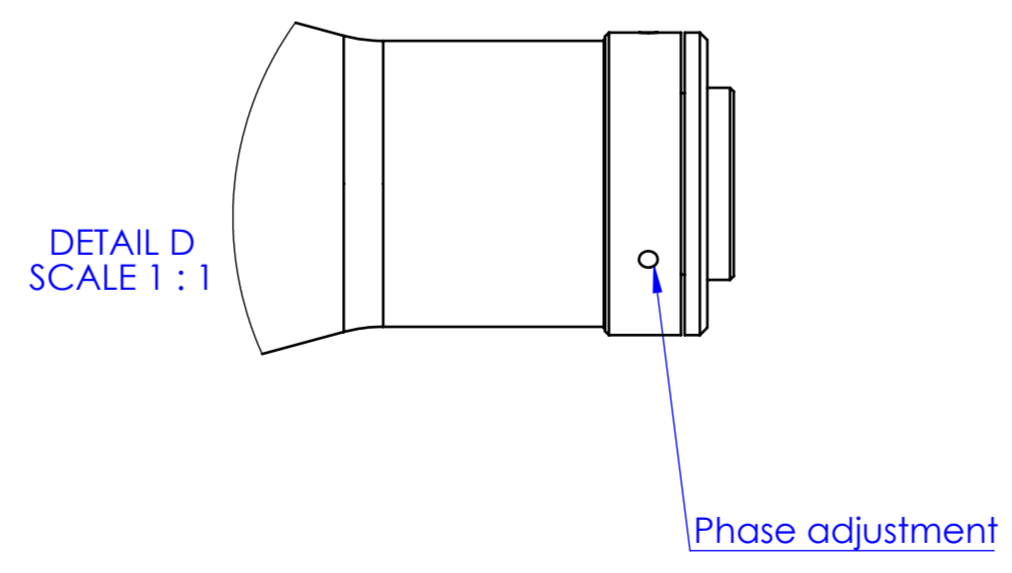
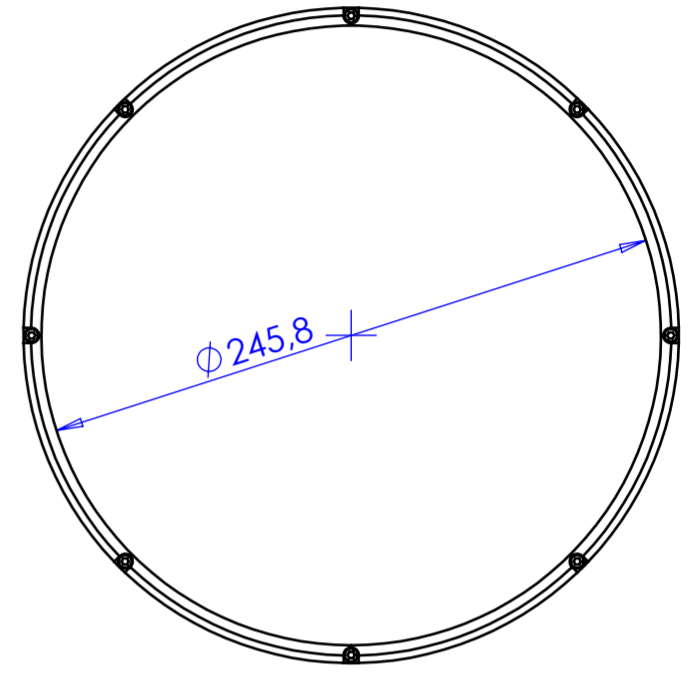
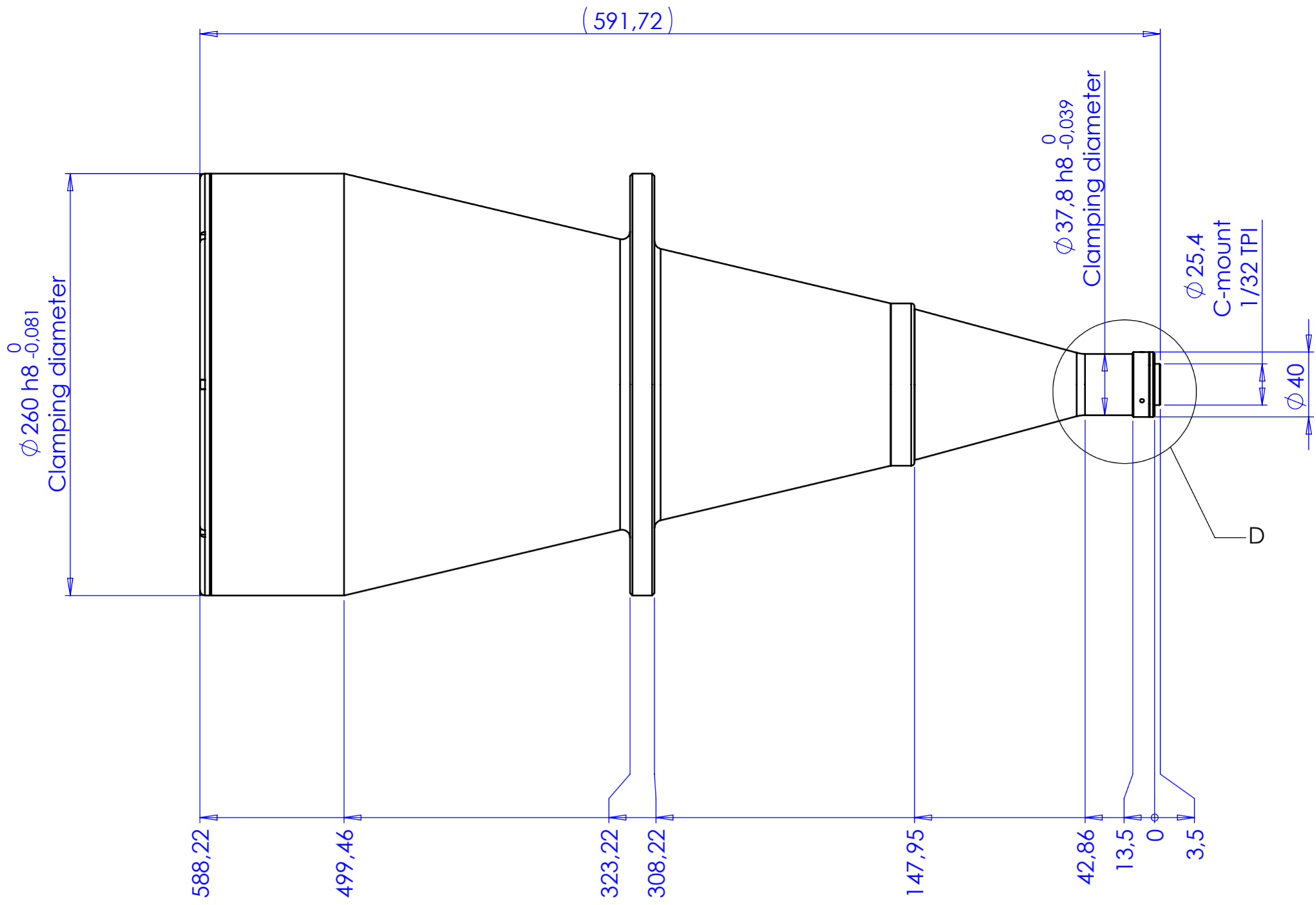
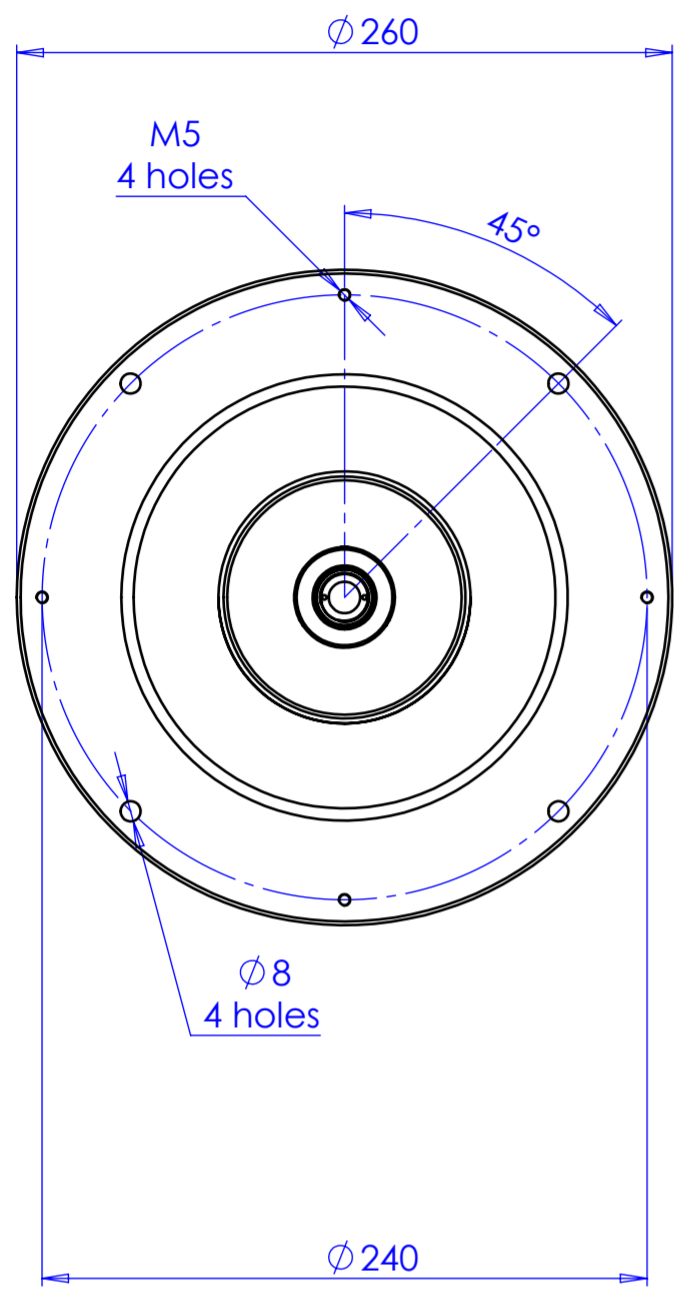

Material	N.A.	Mass	9820 g	Scale	1:3		
Surface treatment	N.A.	Part No.	CO24152				
Geometrical tolerance (ISO 2768-2)	Class	K	Undimensioned bevels	0.5x45°	Description		
Linear tolerance (ISO 2768-2)	Class	m	Undimensioned radii	R 0.5	Obiettivo TC13192		
0.5	>3+	>6+	>30+	>120	>400+	>1000	>2000
+3	6	30	120	+400	1000	+2000	+4000
±0.1	±0.1	±0.2	±0.3	±0.5	±0.8	±1.2	±2
Date		Name		Drawing No.		Sheet	
Designed 20/03/2014		Santini		DP 24152-B		1/1	
Drawn 19/06/2015		Rodella		Secret and confidential - All rights reserved - No copy, dissemination or circulation is allowed unless specifically authorized in writing by OPTO ENGINEERING S.r.l. - Any violation shall be legally prosecuted.			
OPTO ENGINEERING S.r.l. - Mantova Italy - Tel. +39 0376 699111 - www.opto-engineering.com							

0 1 2 3 4 5 6 7 8 9 10