

Rev No.	Description	Date	Name
B	Aggiunta regolazione di fase	23/09/2016	Rodella

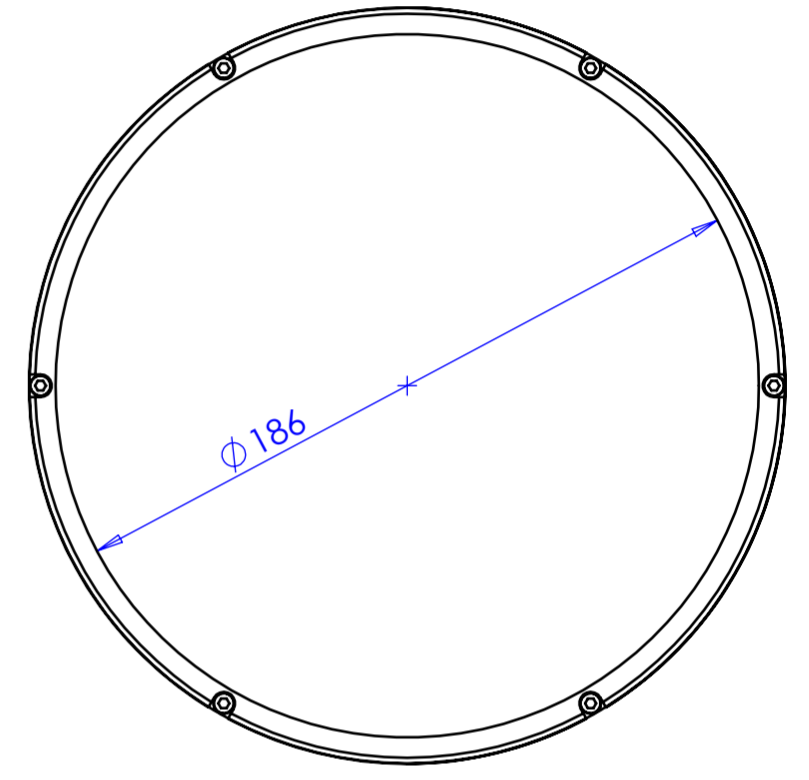

DETAIL D
SCALE 1 : 1

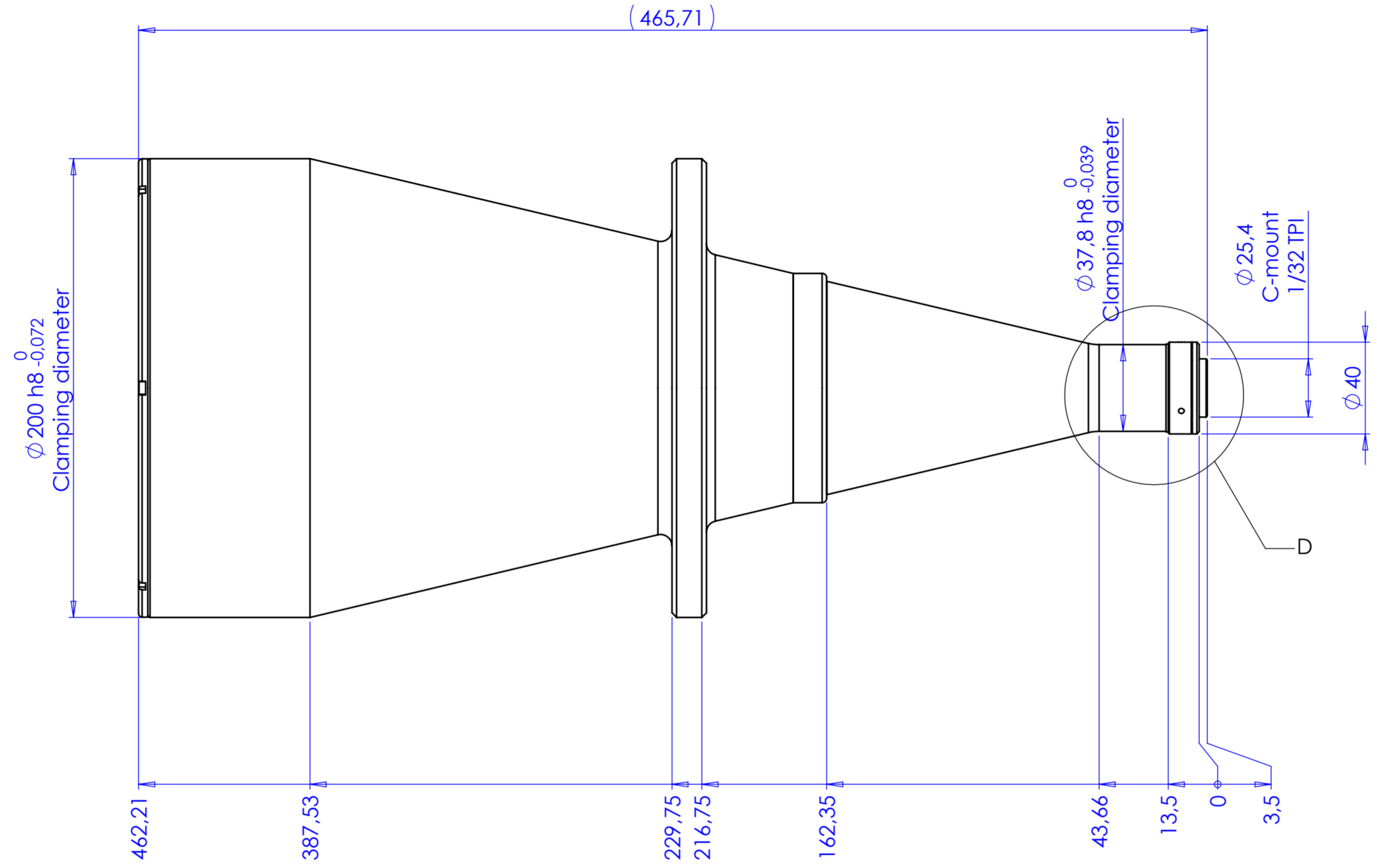
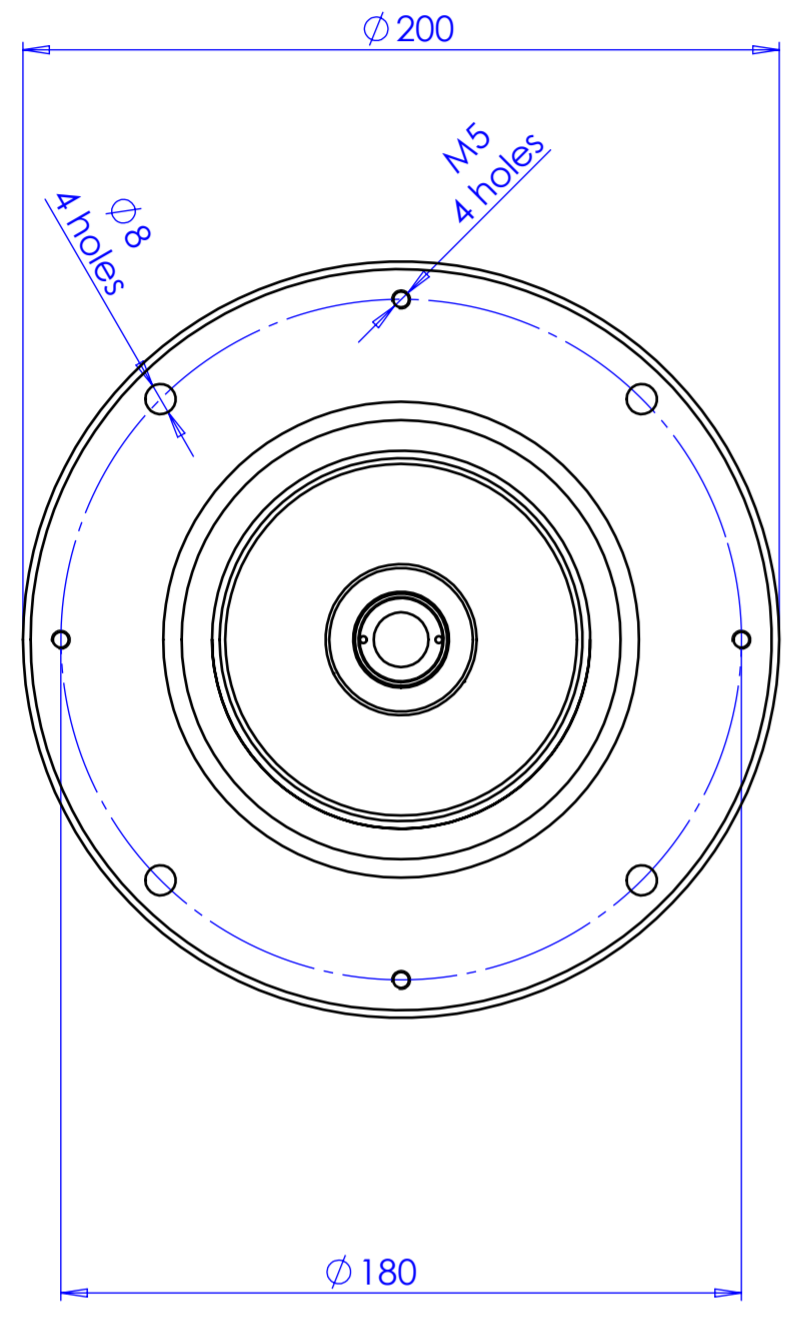
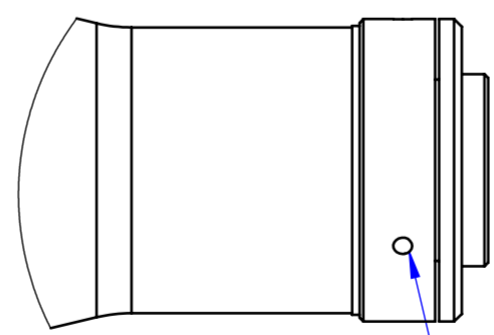

Phase adjustment

Material	N.A.	Mass	5793 g	Scale	1:2			
Surface treatment	N.A.	Part No.	CO02371					
Geometrical tolerance (ISO 2768-2)	Class	K	Undimensioned bevels	0.5x45°	Description			
Linear tolerance (ISO 2768-2)	Class	m	Undimensioned radii	R 0.5	Obiettivo TC12144			
0.5	>3+	>6+	>30+	>120	>400+	>1000	>2000	>4000
+3	6	30	120	+400	1000	+2000	+4000	
±0.1	±0.1	±0.2	±0.3	±0.5	±0.8	±1.2	±2	
Designed		Date		Name				
Drawn		Date		Name				
Checked		Date		Name				
OPTO ENGINEERING S.r.l. - Mantova Italy - Tel. +39 0376 699111 - www.opto-engineering.com								
Drawing No.			DP 02371-B		Sheet			
Date			20/03/2014		1/1			
Name			Santini					
Date			04/03/2015					
Name			Rodella					
<i>Secret and confidential - All rights reserved - No copy, dissemination or circulation is allowed unless specifically authorized in writing by OPTO ENGINEERING S.r.l. - Any violation shall be legally prosecuted.</i>								