

Rev No.	Description	Date	Name
A	TC1348 Layout	04/11/09	

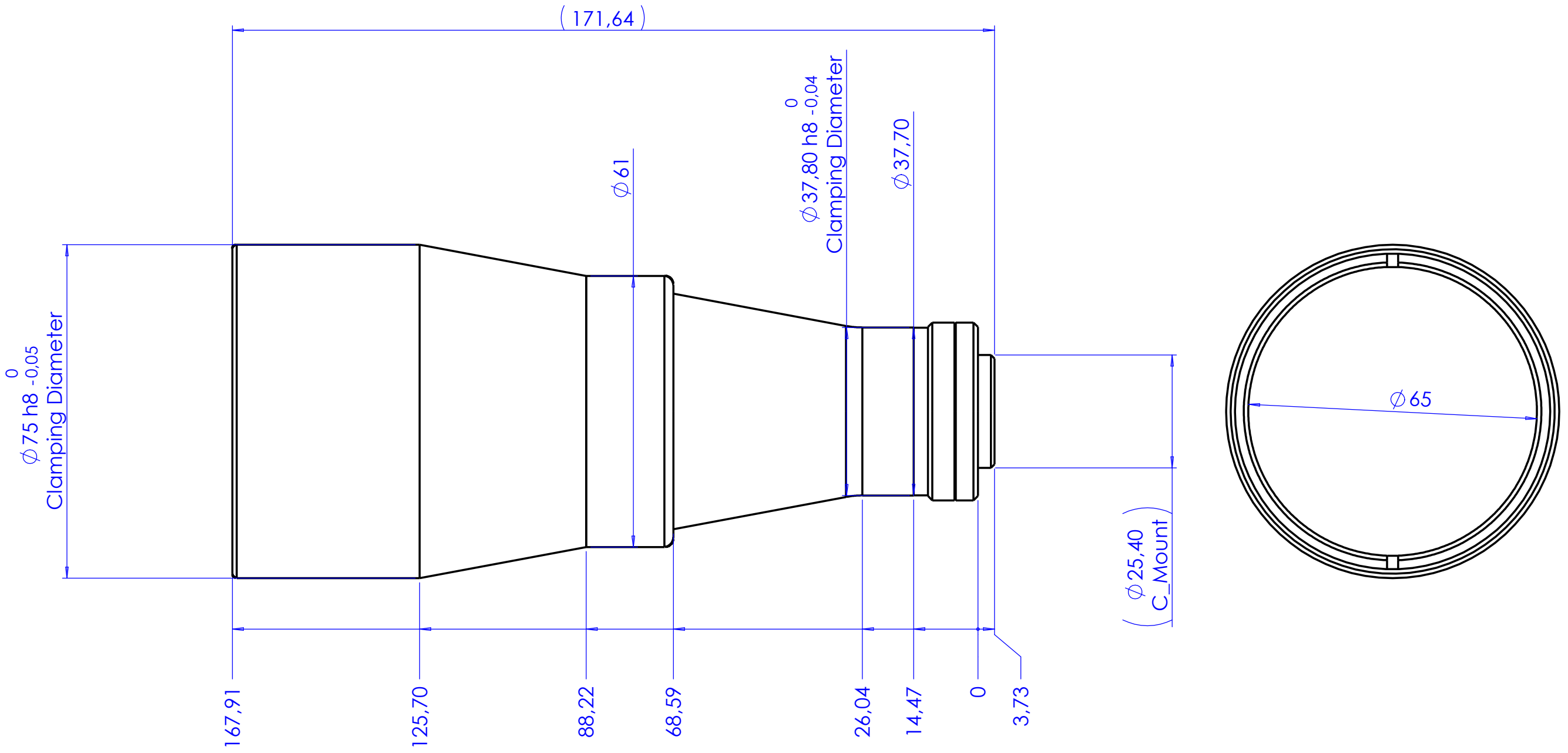

Material	N.A.		Mass	0.8 kg	Scale	1:1																																																												
Surface treatment	N.A.		Project-Prod.item/Instrument																																																															
Geometrical tolerance (ISO 2768-2)			Telecentrico TC1348																																																															
Linear tolerance (ISO 2768-2)			Description																																																															
<table border="1" style="font-size: small;"> <thead> <tr> <th>Class</th> <th>K</th> <th>Undimensioned bevels</th> <th>1x45°</th> <th colspan="2">Description</th> </tr> </thead> <tbody> <tr> <td>0,5</td> <td>>30±</td> <td>>6±</td> <td>>1000</td> <td colspan="2">TC1348 Layout</td> </tr> <tr> <td>±3</td> <td>>120</td> <td>>30±</td> <td>>2000</td> <td colspan="2"> </td> </tr> <tr> <td>±6</td> <td>>400±</td> <td>>120</td> <td>±4000</td> <td colspan="2"> </td> </tr> <tr> <td>±1</td> <td>>1000</td> <td>>30±</td> <td>±2000</td> <td colspan="2"> </td> </tr> <tr> <td>±0,1</td> <td>>2000</td> <td>>120</td> <td>±4000</td> <td colspan="2"> </td> </tr> <tr> <td>±0,1</td> <td>±0,2</td> <td>±0,3</td> <td>±2</td> <td colspan="2"> </td> </tr> <tr> <td>±0,1</td> <td>±0,2</td> <td>±0,3</td> <td>±2</td> <td colspan="2"> </td> </tr> <tr> <td>±0,1</td> <td>±0,2</td> <td>±0,3</td> <td>±2</td> <td colspan="2"> </td> </tr> <tr> <td>±0,1</td> <td>±0,2</td> <td>±0,3</td> <td>±2</td> <td colspan="2"> </td> </tr> </tbody> </table>			Class	K	Undimensioned bevels	1x45°	Description		0,5	>30±	>6±	>1000	TC1348 Layout		±3	>120	>30±	>2000			±6	>400±	>120	±4000			±1	>1000	>30±	±2000			±0,1	>2000	>120	±4000			±0,1	±0,2	±0,3	±2			±0,1	±0,2	±0,3	±2			±0,1	±0,2	±0,3	±2			±0,1	±0,2	±0,3	±2			Drawing No.			
Class	K	Undimensioned bevels	1x45°	Description																																																														
0,5	>30±	>6±	>1000	TC1348 Layout																																																														
±3	>120	>30±	>2000																																																															
±6	>400±	>120	±4000																																																															
±1	>1000	>30±	±2000																																																															
±0,1	>2000	>120	±4000																																																															
±0,1	±0,2	±0,3	±2																																																															
±0,1	±0,2	±0,3	±2																																																															
±0,1	±0,2	±0,3	±2																																																															
±0,1	±0,2	±0,3	±2																																																															
 OPTO ENGINEERING <small>THE TELECENTRIC COMPANY</small>			Date		Name																																																													
			Designed 04/11/09																																																															
			Draw 04/11/09																																																															
Checked X			Drawing No.		Sheet																																																													
			19211-0-A		1/1																																																													
Reproduction forbidden without specific authorization																																																																		
OPTO ENGINEERING S.r.l. - 46100 Mantova Italy - Via Cremona, 29/2 - Tel. +39 0376 263525 - e-mai: info@opto-engineering.com - http://www.opto-engineering.com																																																																		