

Rev No.	Description	Date	Name
A	First light	01/05/03	A.Vismara
D	Redesign	15/02/06	A.Vismara
E	Length of C thread	12/01/09	A.Vismara

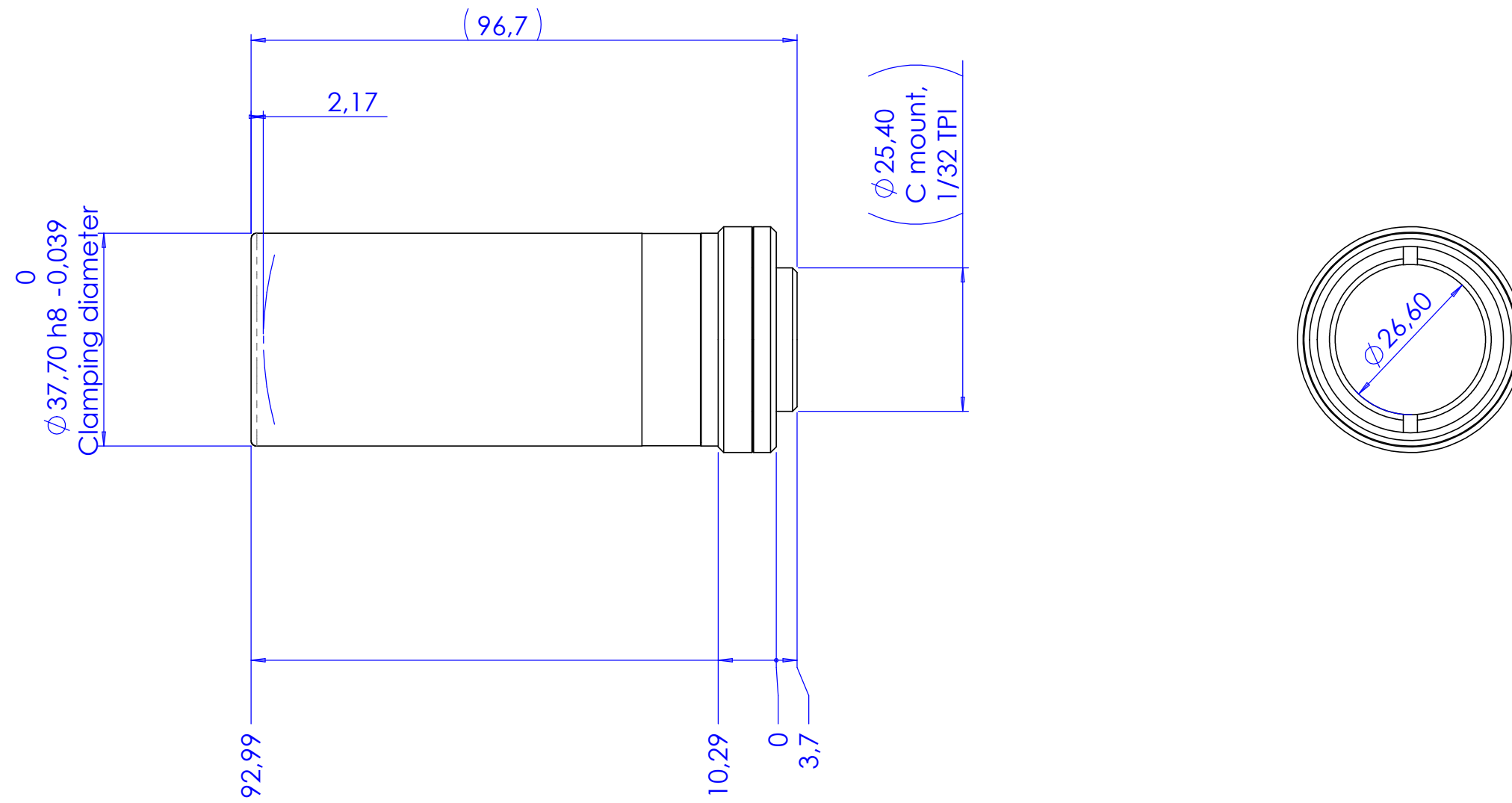

Material		N.A.		Mass		0.26 kg		Scale		1:1			
Surface treatment		N.A.		Project-Prod.item/Instrument		Telecentric lens 12 16							
Geometrical tolerance (ISO 2768-2)				Class		K		Undimensioned bevels		1x45°			
Linear tolerance (ISO 2768-2)				Class		m		Undimensioned radii		R 0.5			
0.5 ±3	>3± 6	>6± 30	>30± 120	>120 ±400	>400± 1000	>1000 ±2000	>2000 ±4000			Description			
±0.1	±0.1	±0.2	±0.3	±0.5	±0.8	±1.2	±2			Assembly			
 www.opto-engineering.com				Date		Name		Drawing No.		Sheet			
				Designed		15/02/06		A.Vismara		01851-0-E		1/1	
				Draw		12/01/09		A.Vismara					
Checked		x		C. Sedazzari		Reproduction forbidden without specific authorization							
OPTO ENGINEERING S.r.l. - 46100 Mantova Italy - Via Cremona, 29/2 - Tel. +39 0376 229585 - e-mai: info@opto-engineering.com - http://www.opto-engineering.com													