

1 2 3 4 5 6 7 8

D

D

C

C

B

B

A

A

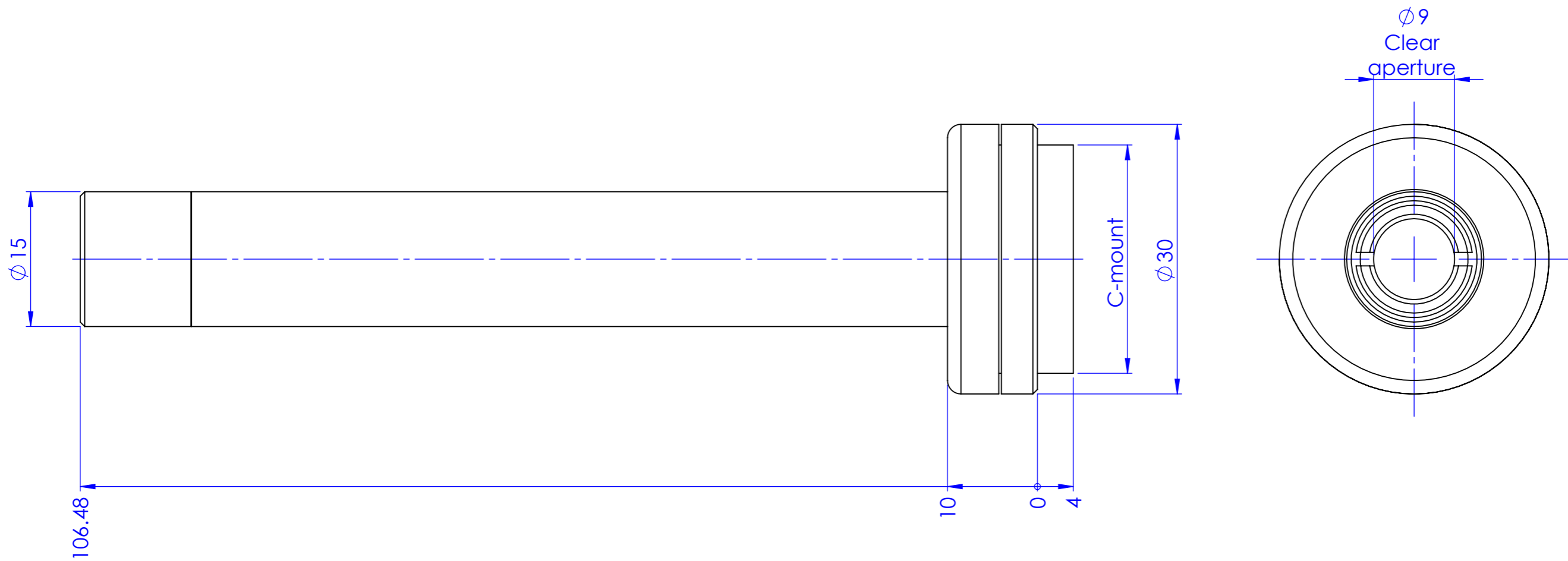

Material		N.A.				Mass	41 g	Scale	2:1		
Surface treatment						Part No. CO50531					
Geometrical tolerance (ISO 2768-2)						Class		K			
Linear tolerance (ISO 2768-2)						Class		m			
0.5	>3±	>6±	>30±	>120	>400±	>1000	>2000	Undimensioned bevels	0.5x45°		
±3	6	30	120	±400	±1000	±2000	±4000	Undimensioned radii	R 0.5		
±0.1	±0.1	±0.2	±0.3	±0.5	±0.8	±1.2	±2	Description			
						Date		Name		Drawing No.	
						Designed		Santini		Sheet	
						Drawn		Rizzotto		1/1	
Checked		Rizzotto		Secret and confidential - All rights reserved - No copy, dissemination or circulation is allowed unless specifically authorized in writing by OPTO ENGINEERING S.r.l. - Any violation shall be legally prosecuted.							
OPTO ENGINEERING S.r.l. - Mantova, Italy - Tel. +39 0376699111 - www.opto-e.com											

all dimensions are in mm

1 2 3 0 1 2 3 4 5 6 7 8 9 10 6 7 8