

SCALE 1:1

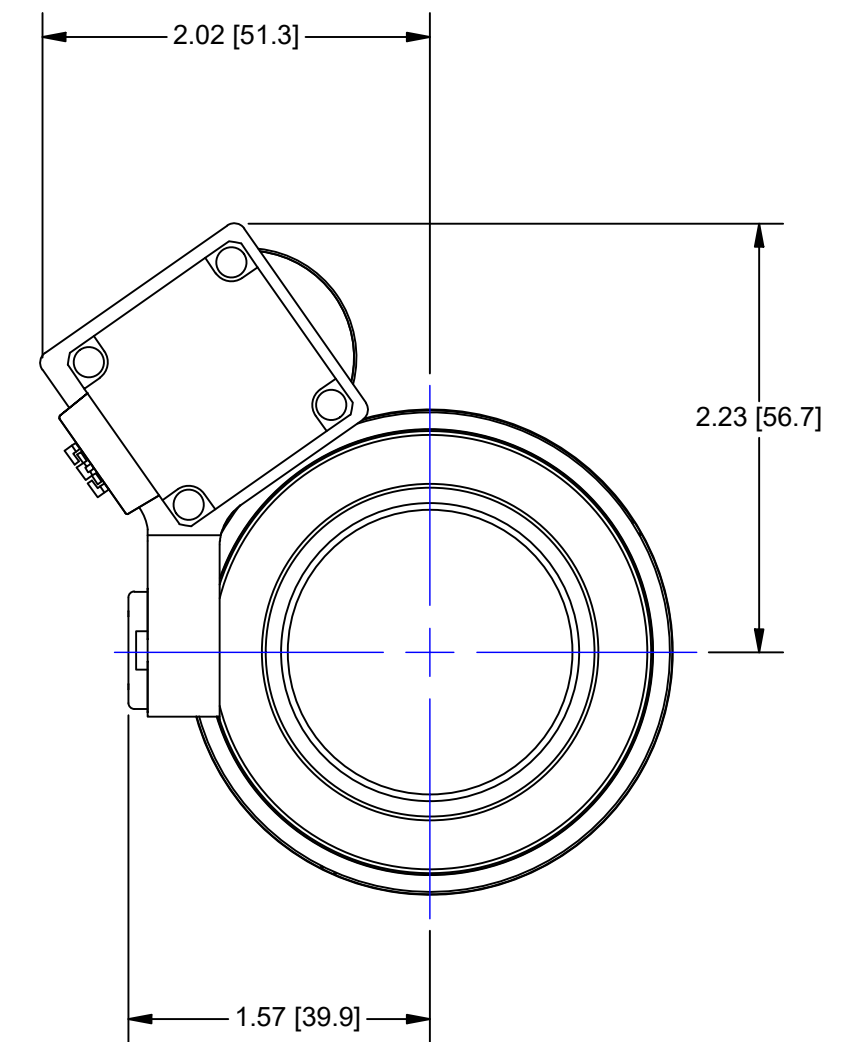
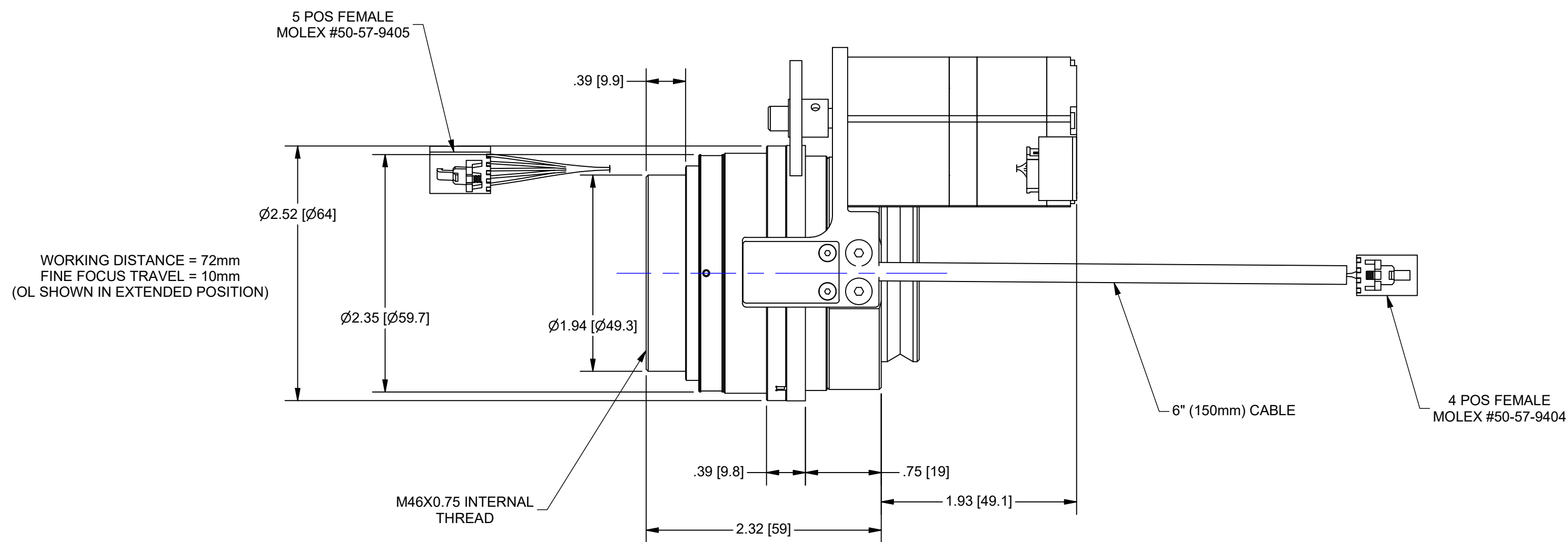

**5φ MOTOR AND HALL EFFECT CABLE INFORMATION:**

- FOCUS / HE CABLE LENGTH = 0.15m  
 - USE NAVITAR #1-40170 (1.8m), 1-40289 (1.2m), 1-40290 (0.6m) TO CONNECT TO NAVITAR 5φ PHASE CONTROLLERS (1-40167, 1-40168, 1-40169),

FF MOTOR  
 5 POSITION FEMALE  
 CONNECTOR  
 (MOLEX #50-57-9405)

HE SENSOR  
 4 POSITION FEMALE  
 CONNECTOR  
 (MOLEX #50-57-9404)

**5φ FF MOTOR PINOUT**  
 PIN 1 = MOTOR 1 (BLUE)  
 PIN 2 = MOTOR 2 (RED)  
 PIN 3 = MOTOR 3 (ORANGE)  
 PIN 4 = MOTOR 4 (GREEN)  
 PIN 5 = MOTOR 5 (BLACK)

**4 PIN HE SENSOR PINOUT**  
 PIN 1 = COMMON  
 PIN 2 = FAR LIMIT  
 PIN 3 = +5VDC  
 PIN 4 = NEAR LIMIT

**OUTLINE**

|  |               |  |  |             |   |
|--|---------------|--|--|-------------|---|
| UNLESS OTHERWISE SPECIFIED DIMENSIONS ARE IN INCHES (MM) AND INCLUDE CHEMICALLY APPLIED OR PLATED FINISHES |               | PROPRIETARY AND CONFIDENTIAL<br>THE INFORMATION CONTAINED IN THIS DRAWING IS THE SOLE PROPERTY OF NAVITAR. ANY REPRODUCTION IN PART OR AS A WHOLE WITHOUT THE WRITTEN PERMISSION OF NAVITAR IS PROHIBITED. |  |             |   |
| SCALE:   | 2:1           |  |  |             |   |
| WEIGHT:  | 0.98 lbmass   | DO NOT SCALE DRAWING   |  | SIZE        | C |
| DR BY:   | J. WILLIAMSON | PROJECT #: E3576   |  | PART NUMBER |   |
| CH BY:   | PB            | DATE DR: 11/29/2017  |  | 1-81205M5   |   |
|  |               |  |  | REV         | A |

MTR FF, 5φ, 1.25X LENS ATTACHMENT