

overview

- 2448 × 2048 px
- Sony IMX264
- 2/3" CMOS
- 24 fps
- Gigabit Ethernet



technical data

| sensor information | | camera features | |
|---|---|---------------------------|--|
| sensor | Sony IMX264 | trigger sources | Hardware software ActionCommand |
| resolution | 2448 × 2048 px | trigger delay | 0 ... 2 sec, tracking and buffering of up to 256 trigger signals |
| exposure time | 0,001 ... 60000 ms | internal image buffer | 115 MB 8 images (Trigger Mode) 1 image (Free Running Mode) |
| pixel size | 3.45 × 3.45 µm | interfaces and connectors | |
| shutter type | Global shutter | data interface | Gigabit Ethernet, Transfer rate 1000 Mb/s/sec, Fast Ethernet, Transfer rate 100 Mb/s/sec, Connector: M12 / 8 pol x-coded, screwable type |
| sensor type | 2/3" CMOS | process interface | M12 / 12 pins a-coded (SACC-CI-M12MS-12CON-L180) |
| acquisition formats | | power supply | via M12/12 pins a-coded or PoE |
| image formats, interface frame rate max. | Full Frame, 2448 × 2048 px, max. 24 fps Binning 2×2, 1224 × 1024 px, max. 35 fps Binning 2×1, 1224 × 2048 px, max. 35 fps Binning 1×2, 2448 × 1024 px, max. 35 fps | mechanical data | |
| image formats, acquisition frame rate max. (Burst Mode) | Full Frame, 2448 × 2048 px, max. 36 fps | lens mount | C-mount |
| pixel formats | Mono8 Mono10 Mono12 Mono12 Packed | width | 40 mm |
| image preprocessing | | height | 40 mm |
| analog controls | Gain (0 ... 48 dB) Offset (0 ... 255 LSB 12 Bit) | depth | 51 mm |
| color models | Mono | weight | ≤ 137 g |
| camera features | | material | aluminum, hard-anodized |
| synchronization | free running trigger | electrical data | |
| | | voltage supply range +Vs | 12 ... 24 V DC (external power supply) 36 ... 57 V DC (Power over Ethernet) |

VCXG-51M.I.XT

Gigabit Ethernet, 5,0 Megapixel, Monochrome

Article number: 11188955

technical data

electrical data

| | |
|-------------------|--|
| power consumption | approx. 2,3 W @ 12 VDC and 24 fps approx. 3,1 W @ 48 VDC (PoE) and 24 fps |
|-------------------|--|

non-volatile memory

| | |
|-------------------|--------|
| flash memory size | 128 kB |
|-------------------|--------|

environmental conditions

| | |
|-----------------------|---|
| operating temperature | -40 ... +70 °C @ T = measurement point |
| humidity | 10 ... 90 % (non-condensing) |
| protection class | IP 40 IP 54 (with mounted tube and cable) IP 65 (with mounted tube and cable) IP 67 (with mounted tube and cable) IP 69K (with stainless steel housing accessory) |

digital I/Os

| | |
|-------|--|
| lines | 4 input lines 4 output lines with pulse width modulation (PWM) (max. 48 V / max. 2,5 A) |
|-------|--|

conformity

| | |
|------------|-------------------|
| conformity | CE RoHS EAC |
|------------|-------------------|

Principle

dimension drawing

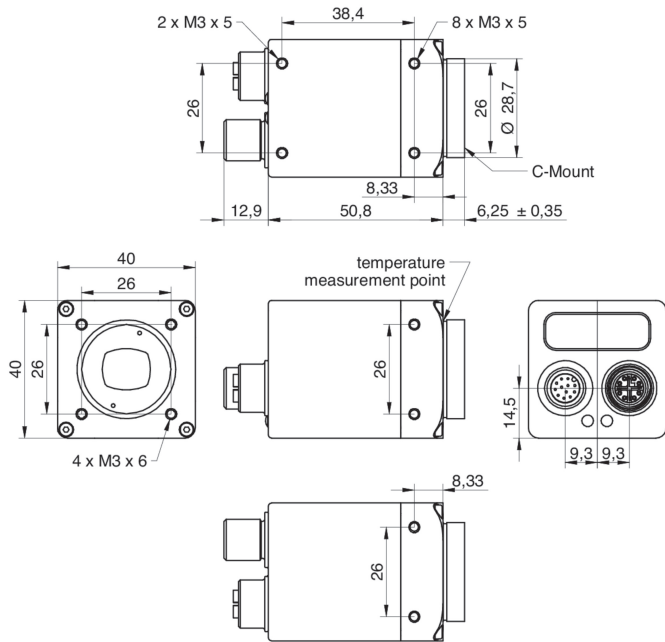

Principle

Optional accessories for protection class IP65/67:

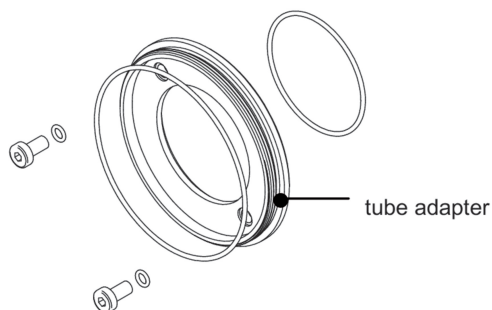

tube adapter

- Ø 49,5 mm, hard-anodized, incl. sealing and screws (VCXG.I 11185373)
- Ø 65 mm, hard-anodized, incl. sealing and screws (VCXG.I 11185377; VLXT 11193125)

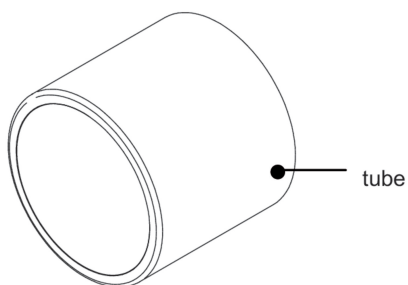

tube

- Ø 49,5 mm, length 44 mm, hard-anodized, cover glass PMMA (11185370)
- Ø 65 mm, length 58 mm, hard-anodized, cover glass PMMA (11185374)
- Ø 49,5 mm, length 44 mm, hard-anodized, tempered laminated safety glass (11195425)
- Ø 65 mm, length 58 mm, hard-anodized, tempered laminated safety glass (11195426)

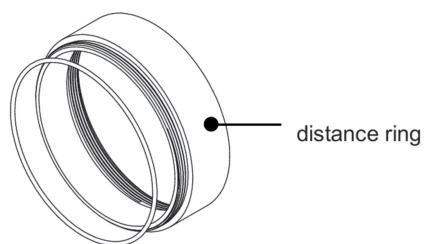

distance ring

- Ø 49,5 mm, length 12 mm, hard-anodized, incl. sealing (11185371)
- Ø 49,5 mm, length 6 mm, hard-anodized, incl. sealing (11185372)
- Ø 65 mm, length 12 mm, hard-anodized, incl. sealing (11185375)
- Ø 65 mm, length 6 mm, hard-anodized, incl. sealing (11185376)
- Ø 65 mm, length 36 mm, hard-anodized, incl. sealing (111988906)